

FLOORS

3-17

RESIDENCE A

4 BEDROOMS
5 BATHROOMS
POWDER ROOM
DEN / SERVICE

INTERIOR
4,810 SF | 447 SQM

EXTERIOR
388 SF | 36 SQM

TOTAL
5,198 SF | 483 SQM

RESIDENCE B

4 BEDROOMS
5 BATHROOMS
POWDER ROOM
DEN / SERVICE

INTERIOR
4,358 SF | 405 SQM

EXTERIOR
388 SF | 36 SQM

TOTAL
4,746 SF | 441 SQM

RESIDENCE C

3 BEDROOMS
3 BATHROOMS
POWDER ROOM

INTERIOR
3,297 SF | 306 SQM

EXTERIOR
585 SF | 54 SQM

TOTAL
3,882 SF | 361 SQM

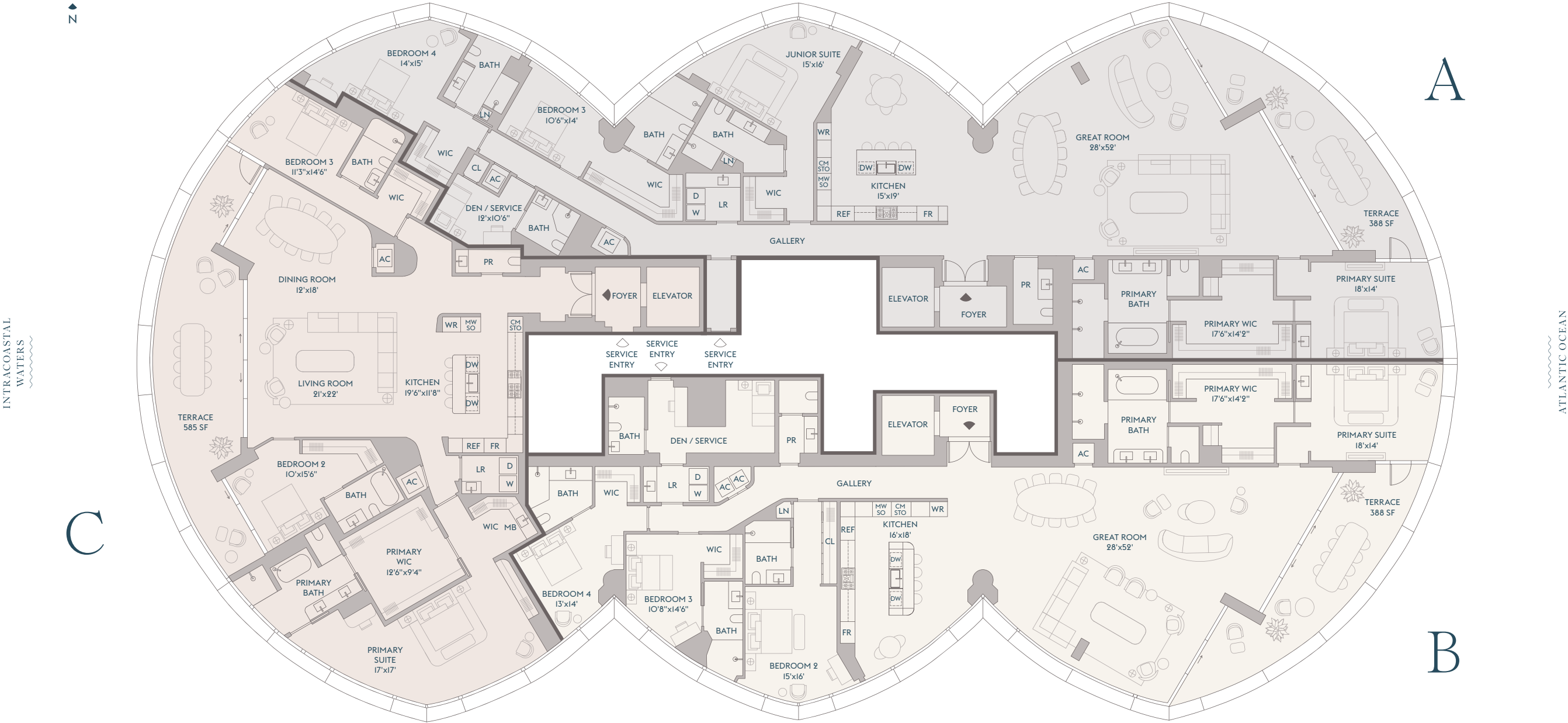

The dimensions stated for this floor plan are approximate because there are various recognized methods for calculating the square footage of a unit. The square footage stated here is calculated from the exterior boundaries of the exterior walls to the centerline of interior demising walls without deductions for cutouts, curves, or architectural features. This method typically results in quoted dimensions greater than the dimensions that would be determined by using other accepted methods. The definition of "Unit" and the calculation method to be relied upon is set forth by the Developer in Developer's prospectus which method may result in a square footage calculation less than the result of the calculation method used here. Renderings depict features not included with purchase, but which are available at an additional cost such as wine bar and closet millwork among others. Consult the Developer's prospectus to learn what is included with Unit purchase and to understand Unit dimensions. 2024 © Carlton Terrace Owner LLC, with all rights reserved.

FLOORS

18-21

RESIDENCE A

4 BEDROOMS
6 BATHROOMS
POWDER ROOM
OFFICE / BEDROOM
FAMILY ROOM
DEN
SERVICE

INTERIOR
6,655 SF | 618 SQM

EXTERIOR
876 SF | 81 SQM

TOTAL
7,531 SF | 700 SQM

RESIDENCE B

4 BEDROOMS
6 BATHROOMS
POWDER ROOM
OFFICE / BEDROOM
FAMILY ROOM
SERVICE

INTERIOR
5,810 SF | 540 SQM

EXTERIOR
485 SF | 45 SQM

TOTAL
6,295 SF | 585 SQM

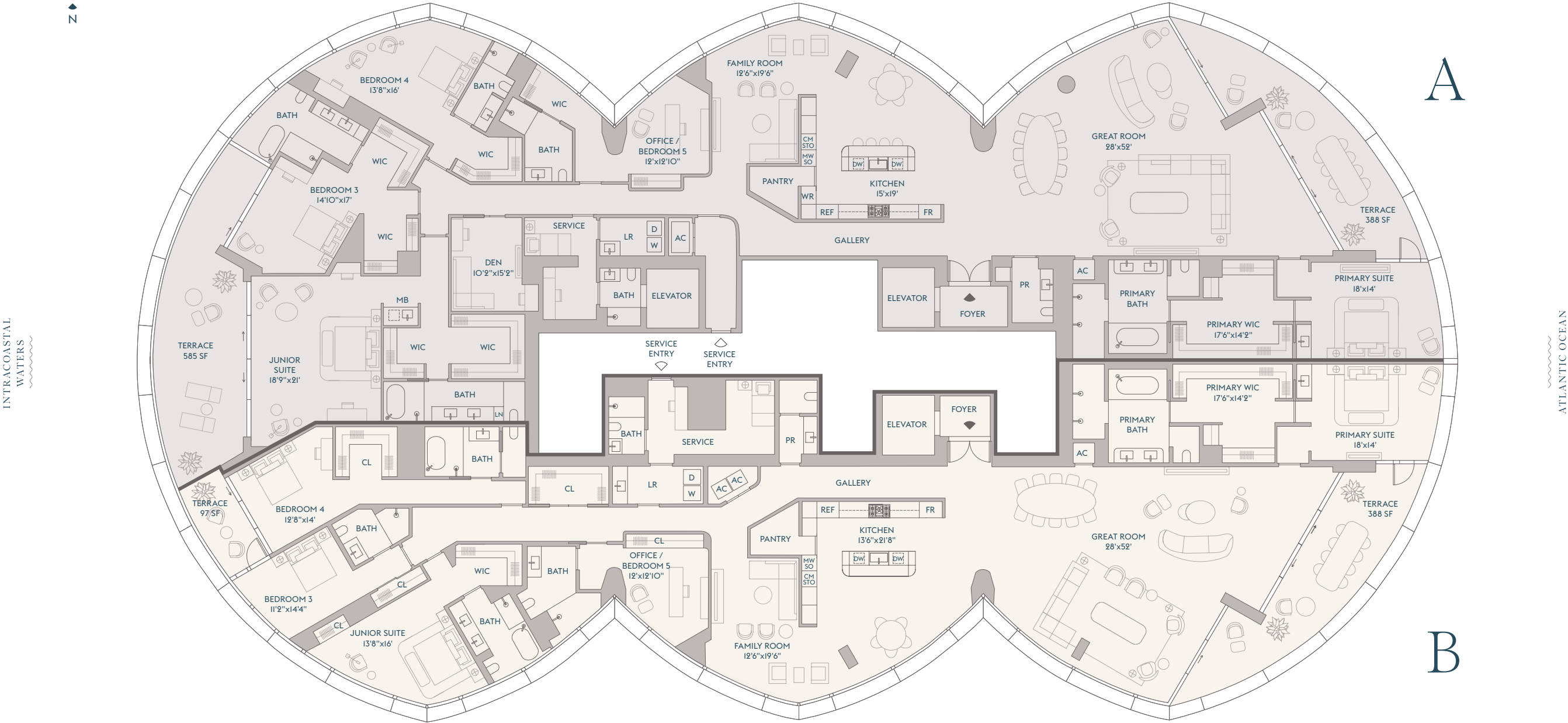

The dimensions stated for this floor plan are approximate because there are various recognized methods for calculating the square footage of a unit. The square footage stated here is calculated from the exterior boundaries of the exterior walls to the centerline of interior demising walls without deductions for cutouts, curves, or architectural features. This method typically results in quoted dimensions greater than the dimensions that would be determined by using other accepted methods. The definition of "Unit" and the calculation method to be relied upon is set forth by the Developer in Developer's prospectus which method may result in a square footage calculation less than the result of the calculation method used here. Renderings depict features not included with purchase, but which are available at an additional cost such as wine bar and closet millwork among others. Consult the Developer's prospectus to learn what is included with Unit purchase and to understand Unit dimensions. 2024 © Carlton Terrace Owner LLC, with all rights reserved.

RIVAGE

BAL HARBOUR

RESIDENCE
A
FLOOR
2

4 BEDROOMS
5 BATHROOMS
POWDER ROOM
DEN / SERVICE

INTERIOR
4,784 SF | 444 SQM
EXTERIOR
388 SF | 36 SQM

TOTAL
5,172 SF | 480 SQM

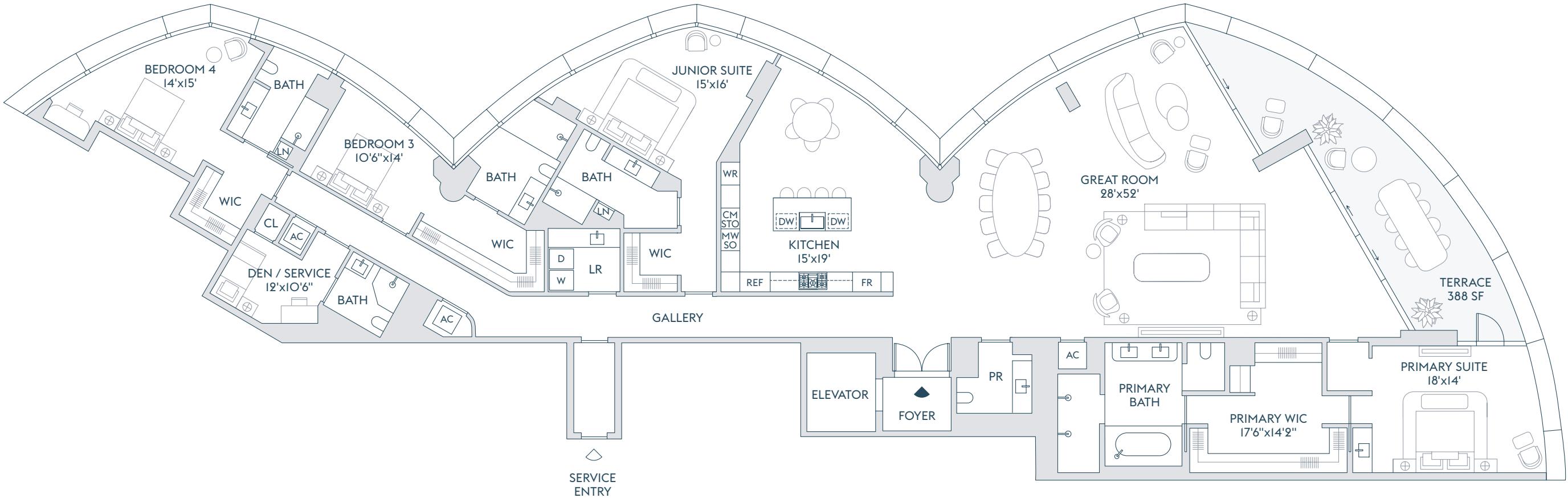

INTRACOASTAL
WATERS

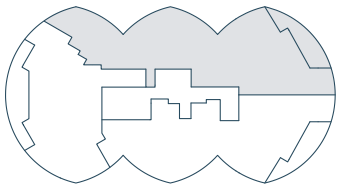

ATLANTIC OCEAN

The dimensions stated for this floor plan are approximate because there are various recognized methods for calculating the square footage of a unit. The square footage stated here is calculated from the exterior boundaries of the exterior walls to the centerline of interior demising walls without deductions for cutouts, curves, or architectural features. This method typically results in quoted dimensions greater than the dimensions that would be determined by using other accepted methods. The definition of "Unit" and the calculation method to be relied upon is set forth by the Developer in Developer's prospectus which method may result in a square footage calculation less than the result of the calculation method used here. Renderings depict features not included with purchase, but which are available at an additional cost such as wine bar and closet millwork among others. Consult the Developer's prospectus to learn what is included with Unit purchase and to understand Unit dimensions. 2024 © Carlton Terrace Owner LLC, with all rights reserved.

RIVAGE

BAL HARBOUR

RESIDENCE
A
FLOOR
2

4 BEDROOMS
5 BATHROOMS
POWDER ROOM
DEN / SERVICE

INTERIOR
4,784 SF | 444 SQM

EXTERIOR
388 SF | 36 SQM

TOTAL
5,172 SF | 480 SQM

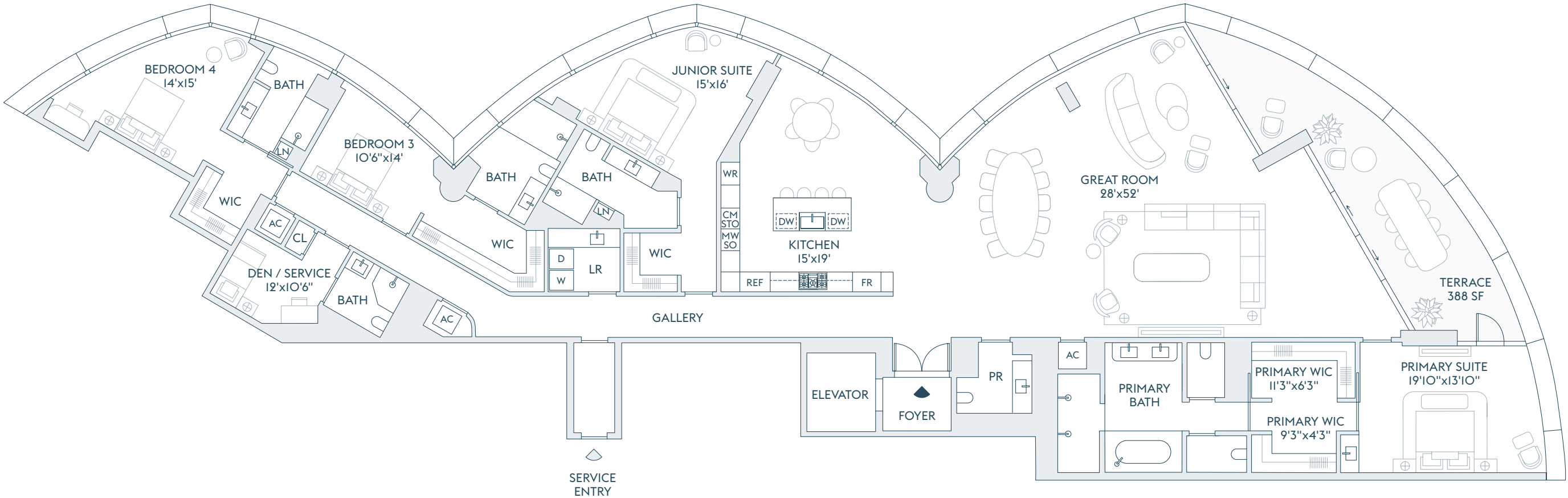

INTRACOASTAL
WATERS

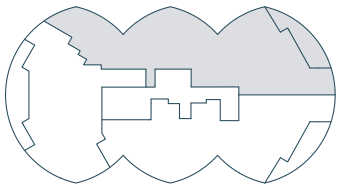

ATLANTIC OCEAN

ALTERNATE PRIMARY SUITE

The dimensions stated for this floor plan are approximate because there are various recognized methods for calculating the square footage of a unit. The square footage stated here is calculated from the exterior boundaries of the exterior walls to the centerline of interior demising walls without deductions for cutouts, curves, or architectural features. This method typically results in quoted dimensions greater than the dimensions that would be determined by using other accepted methods. The definition of "Unit" and the calculation method to be relied upon is set forth by the Developer in Developer's prospectus which method may result in a square footage calculation less than the result of the calculation method used here. Renderings depict features not included with purchase, but which are available at an additional cost such as wine bar and closet millwork among others. Consult the Developer's prospectus to learn what is included with Unit purchase and to understand Unit dimensions. 2024 © Carlton Terrace Owner LLC, with all rights reserved.

RIVAGE

BAL HARBOUR

RESIDENCE

A

FLOORS

3-17

4 BEDROOMS
5 BATHROOMS
POWDER ROOM
DEN / SERVICE

INTERIOR
4,810 SF | 447 SQM

EXTERIOR
388 SF | 36 SQM

TOTAL
5,198 SF | 483 SQM

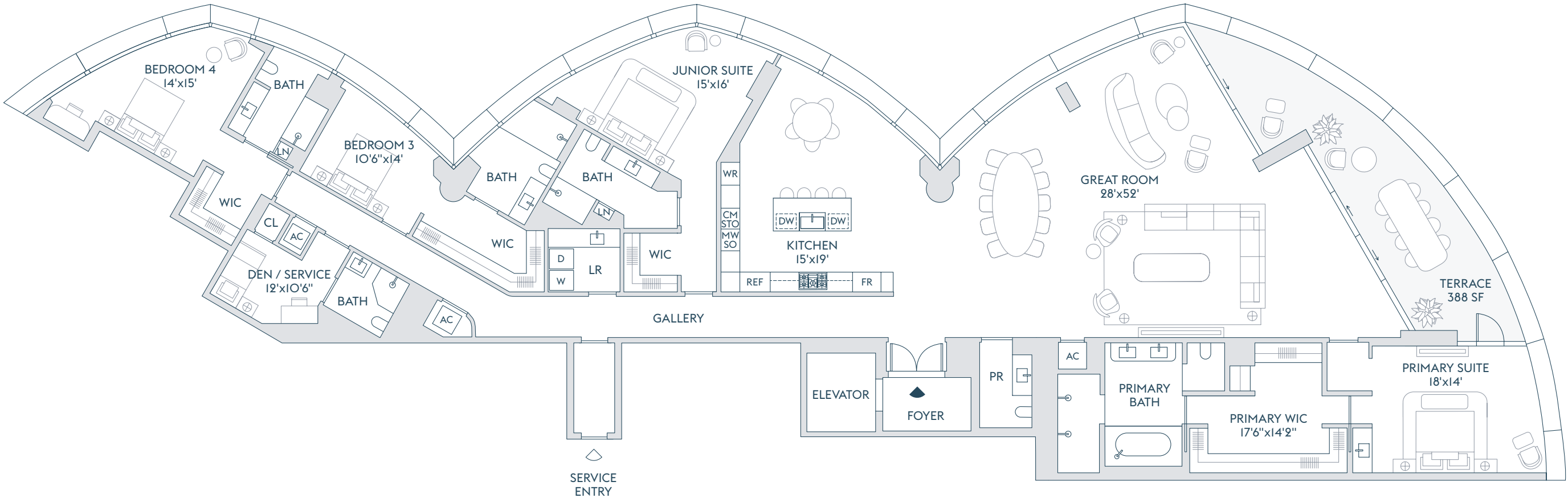

INTRACOASTAL
WATERS

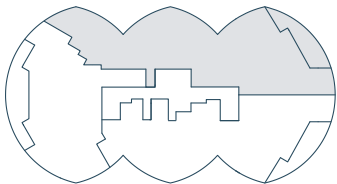

ATLANTIC OCEAN

The dimensions stated for this floor plan are approximate because there are various recognized methods for calculating the square footage of a unit. The square footage stated here is calculated from the exterior boundaries of the exterior walls to the centerline of interior demising walls without deductions for cutouts, curves, or architectural features. This method typically results in quoted dimensions greater than the dimensions that would be determined by using other accepted methods. The definition of "Unit" and the calculation method to be relied upon is set forth by the Developer in Developer's prospectus which method may result in a square footage calculation less than the result of the calculation method used here. Renderings depict features not included with purchase, but which are available at an additional cost such as wine bar and closet millwork among others. Consult the Developer's prospectus to learn what is included with Unit purchase and to understand Unit dimensions. 2024 © Carlton Terrace Owner LLC, with all rights reserved.

RIVAGE

BAL HARBOUR

RESIDENCE

A

FLOORS

3-17

4 BEDROOMS
5 BATHROOMS
POWDER ROOM
DEN / SERVICE

INTERIOR
4,810 SF | 447 SQM

EXTERIOR
388 SF | 36 SQM

TOTAL
5,198 SF | 483 SQM

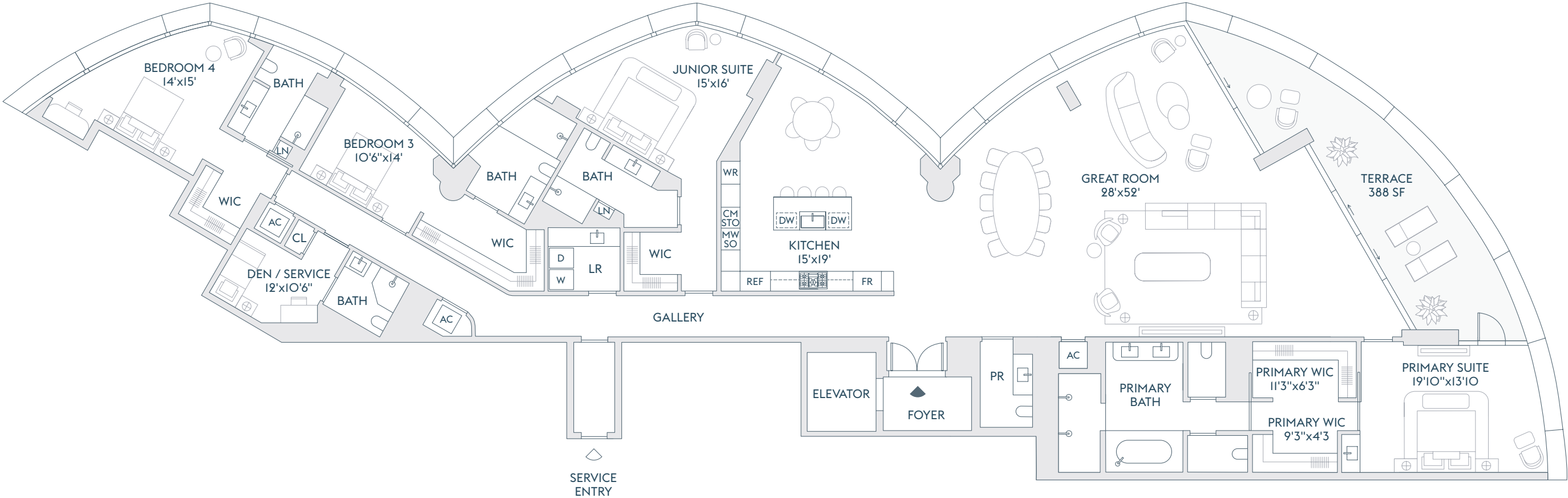

INTRACOASTAL
WATERS

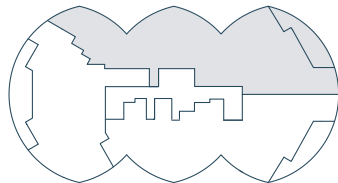

ATLANTIC OCEAN

ALTERNATE PRIMARY BEDROOM

The dimensions stated for this floor plan are approximate because there are various recognized methods for calculating the square footage of a unit. The square footage stated here is calculated from the exterior boundaries of the exterior walls to the centerline of interior demising walls without deductions for cutouts, curves, or architectural features. This method typically results in quoted dimensions greater than the dimensions that would be determined by using other accepted methods. The definition of "Unit" and the calculation method to be relied upon is set forth by the Developer in Developer's prospectus which method may result in a square footage calculation less than the result of the calculation method used here. Renderings depict features not included with purchase, but which are available at an additional cost such as wine bar and closet millwork among others. Consult the Developer's prospectus to learn what is included with Unit purchase and to understand Unit dimensions. 2024 © Carlton Terrace Owner LLC, with all rights reserved.

RIVAGE

BAL HARBOUR

RESIDENCE

A

FLOORS

18-21

4 BEDROOMS
6 BATHROOMS
POWDER ROOM
OFFICE / BEDROOM
FAMILY ROOM
DEN
SERVICE

INTERIOR
6,655 SF | 618 SQM

EXTERIOR
876 SF | 81 SQM

TOTAL
7,531 SF | 700 SQM

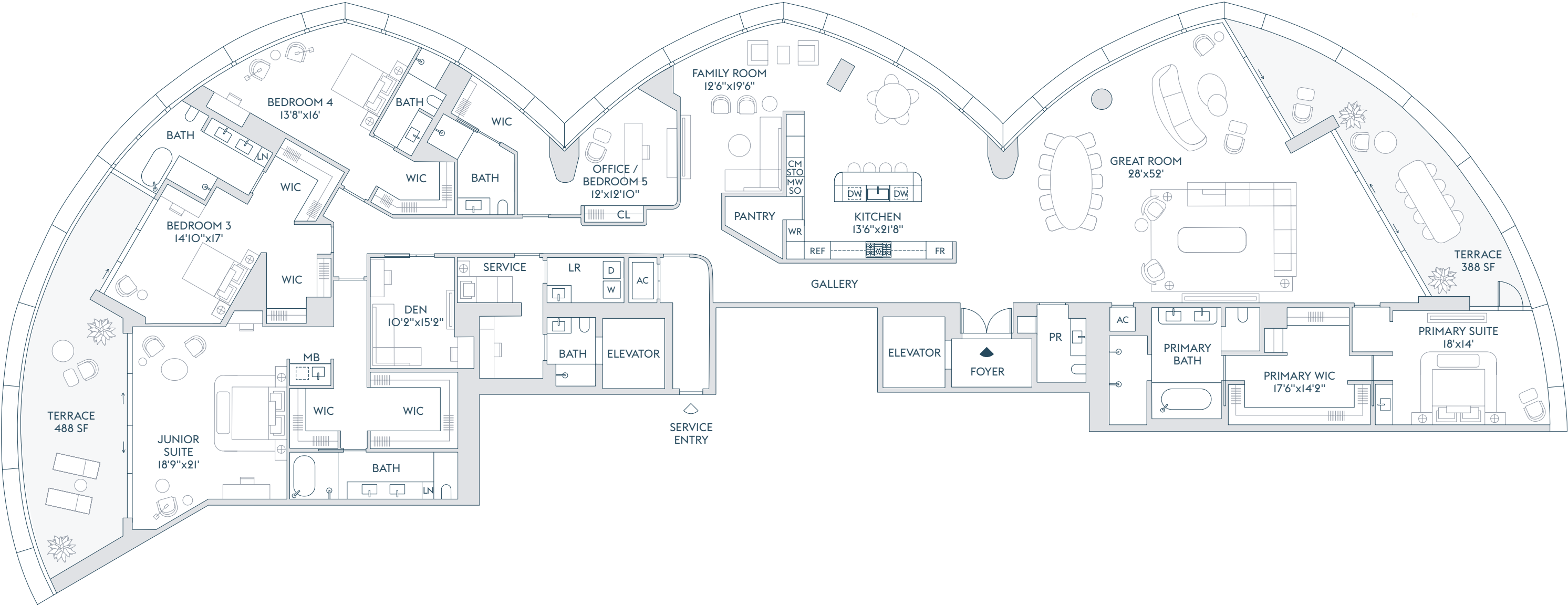

INTRACOASTAL
WATERS

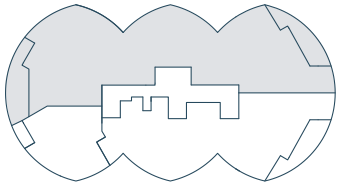

ATLANTIC OCEAN

The dimensions stated for this floor plan are approximate because there are various recognized methods for calculating the square footage of a unit. The square footage stated here is calculated from the exterior boundaries of the exterior walls to the centerline of interior demising walls without deductions for cutouts, curves, or architectural features. This method typically results in quoted dimensions greater than the dimensions that would be determined by using other accepted methods. The definition of "Unit" and the calculation method to be relied upon is set forth by the Developer in Developer's prospectus which method may result in a square footage calculation less than the result of the calculation method used here. Renderings depict features not included with purchase, but which are available at an additional cost such as wine bar and closet millwork among others. Consult the Developer's prospectus to learn what is included with Unit purchase and to understand Unit dimensions. 2024 © Carlton Terrace Owner LLC, with all rights reserved.

RIVAGE

BAL HARBOUR

RESIDENCE

A

FLOORS

18-21

4 BEDROOMS
6 BATHROOMS
POWDER ROOM
OFFICE / BEDROOM
FAMILY ROOM
DEN
SERVICE

INTERIOR
6,655 SF | 618 SQM

EXTERIOR
876 SF | 81 SQM

TOTAL
7,531 SF | 700 SQM

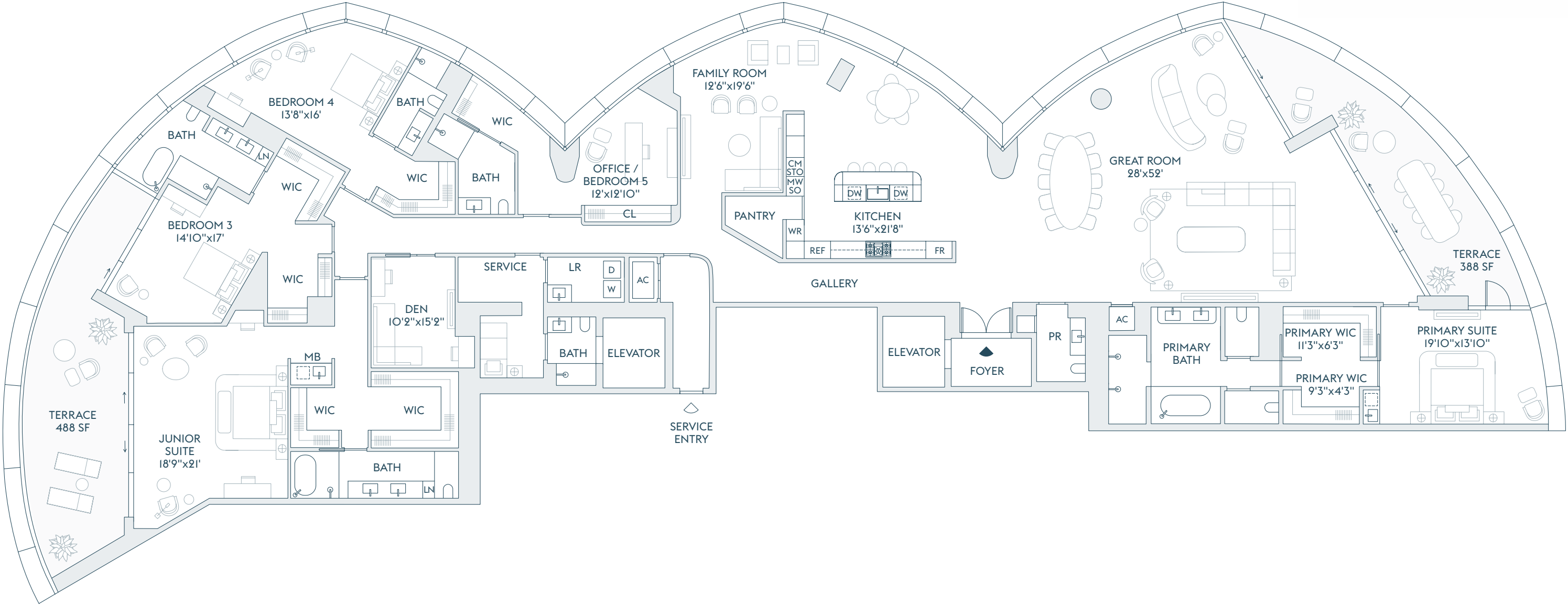

INTRACOASTAL
WATERS

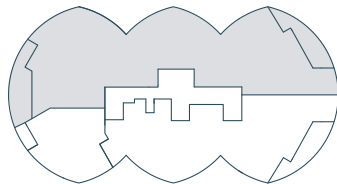

ATLANTIC OCEAN

ALTERNATE PRIMARY SUITE

The dimensions stated for this floor plan are approximate because there are various recognized methods for calculating the square footage of a unit. The square footage stated here is calculated from the exterior boundaries of the exterior walls to the centerline of interior demising walls without deductions for cutouts, curves, or architectural features. This method typically results in quoted dimensions greater than the dimensions that would be determined by using other accepted methods. The definition of "Unit" and the calculation method to be relied upon is set forth by the Developer in Developer's prospectus which method may result in a square footage calculation less than the result of the calculation method used here. Renderings depict features not included with purchase, but which are available at an additional cost such as wine bar and closet millwork among others. Consult the Developer's prospectus to learn what is included with Unit purchase and to understand Unit dimensions. 2024 © Carlton Terrace Owner LLC, with all rights reserved.

RIVAGE

BAL HARBOUR

RESIDENCE
B
FLOOR
2

4 BEDROOMS
5 BATHROOMS
POWDER ROOM
DEN / SERVICE

INTERIOR
4,215 SF | 392 SQM

EXTERIOR
388 SF | 36 SQM

TOTAL
4,603 SF | 428 SQM

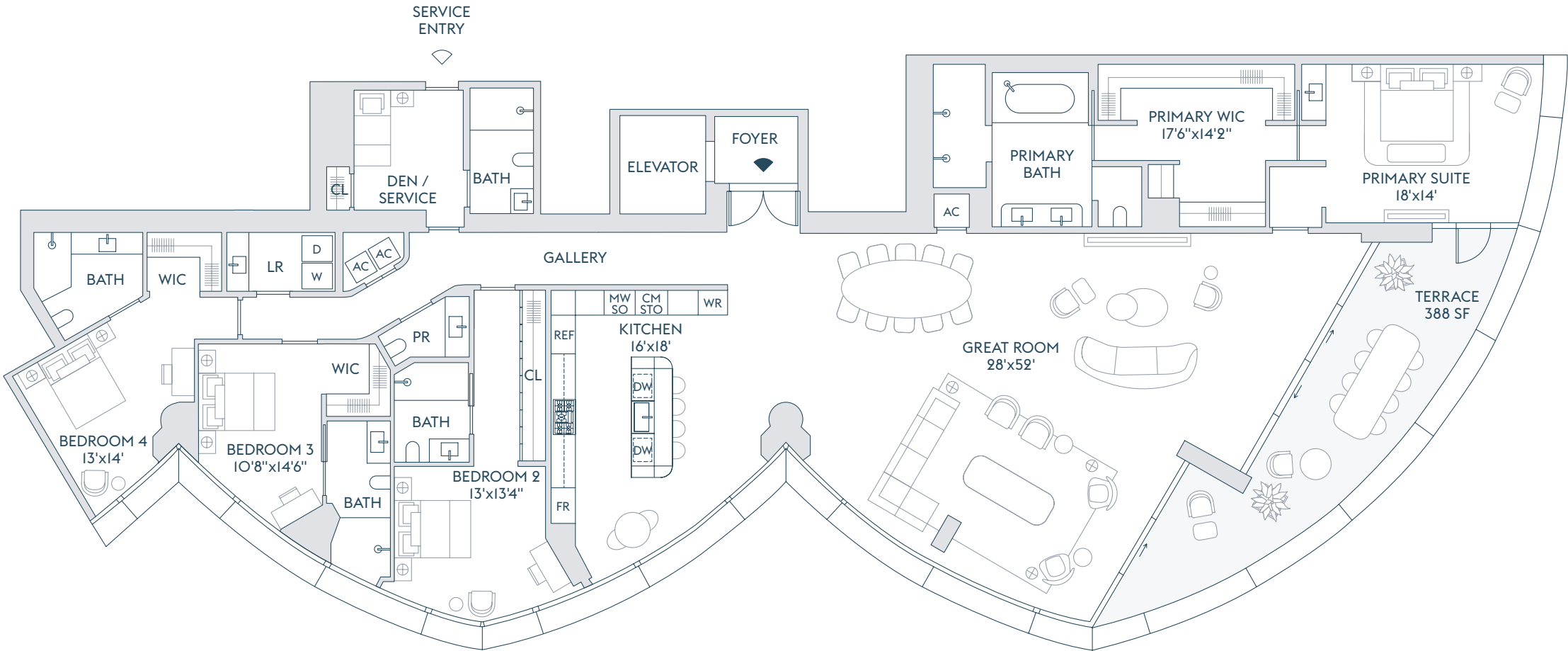

INTRACOASTAL
WATERS

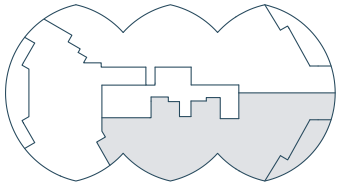

ATLANTIC OCEAN

The dimensions stated for this floor plan are approximate because there are various recognized methods for calculating the square footage of a unit. The square footage stated here is calculated from the exterior boundaries of the exterior walls to the centerline of interior demising walls without deductions for cutouts, curves, or architectural features. This method typically results in quoted dimensions greater than the dimensions that would be determined by using other accepted methods. The definition of "Unit" and the calculation method to be relied upon is set forth by the Developer in Developer's prospectus which method may result in a square footage calculation less than the result of the calculation method used here. Renderings depict features not included with purchase, but which are available at an additional cost such as wine bar and closet millwork among others. Consult the Developer's prospectus to learn what is included with Unit purchase and to understand Unit dimensions. 2024 © Carlton Terrace Owner LLC, with all rights reserved.

RIVAGE

BAL HARBOUR

RESIDENCE
B
FLOOR
2

4 BEDROOMS
5 BATHROOMS
POWDER ROOM
DEN / SERVICE

INTERIOR
4,215 SF | 392 SQM
EXTERIOR
388 SF | 36 SQM

TOTAL
4,603 SF | 428 SQM

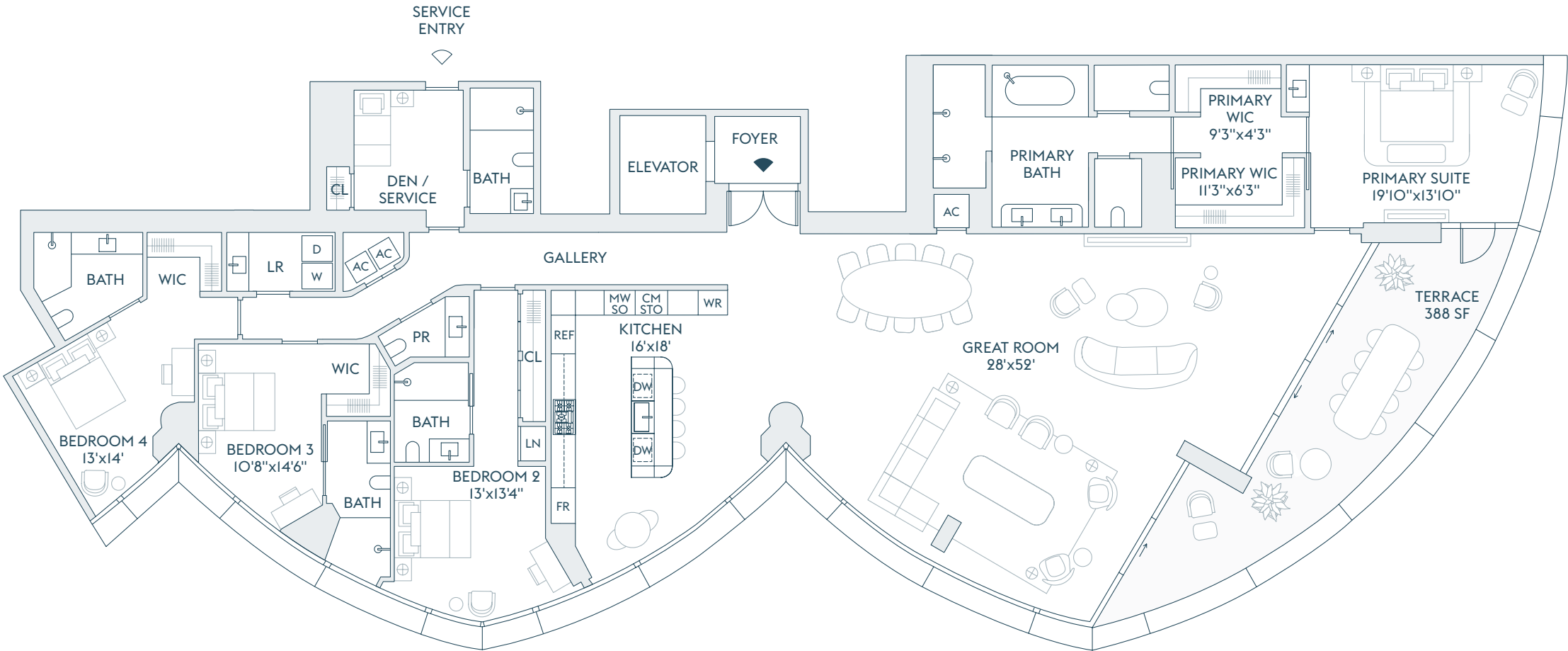

INTRACOASTAL
WATERS

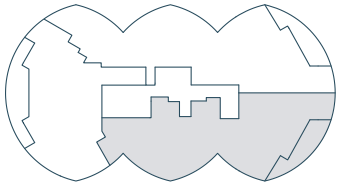

ATLANTIC OCEAN

ALTERNATE PRIMARY SUITE

The dimensions stated for this floor plan are approximate because there are various recognized methods for calculating the square footage of a unit. The square footage stated here is calculated from the exterior boundaries of the exterior walls to the centerline of interior demising walls without deductions for cutouts, curves, or architectural features. This method typically results in quoted dimensions greater than the dimensions that would be determined by using other accepted methods. The definition of "Unit" and the calculation method to be relied upon is set forth by the Developer in Developer's prospectus which method may result in a square footage calculation less than the result of the calculation method used here. Renderings depict features not included with purchase, but which are available at an additional cost such as wine bar and closet millwork among others. Consult the Developer's prospectus to learn what is included with Unit purchase and to understand Unit dimensions. 2024 © Carlton Terrace Owner LLC, with all rights reserved.

RIVAGE

BAL HARBOUR

RESIDENCE

B

FLOORS

3-17

4 BEDROOMS
5 BATHROOMS
POWDER ROOM
DEN / SERVICE

INTERIOR
4,358 SF | 405 SQM

EXTERIOR
388 SF | 36 SQM

TOTAL
4,746 SF | 441 SQM

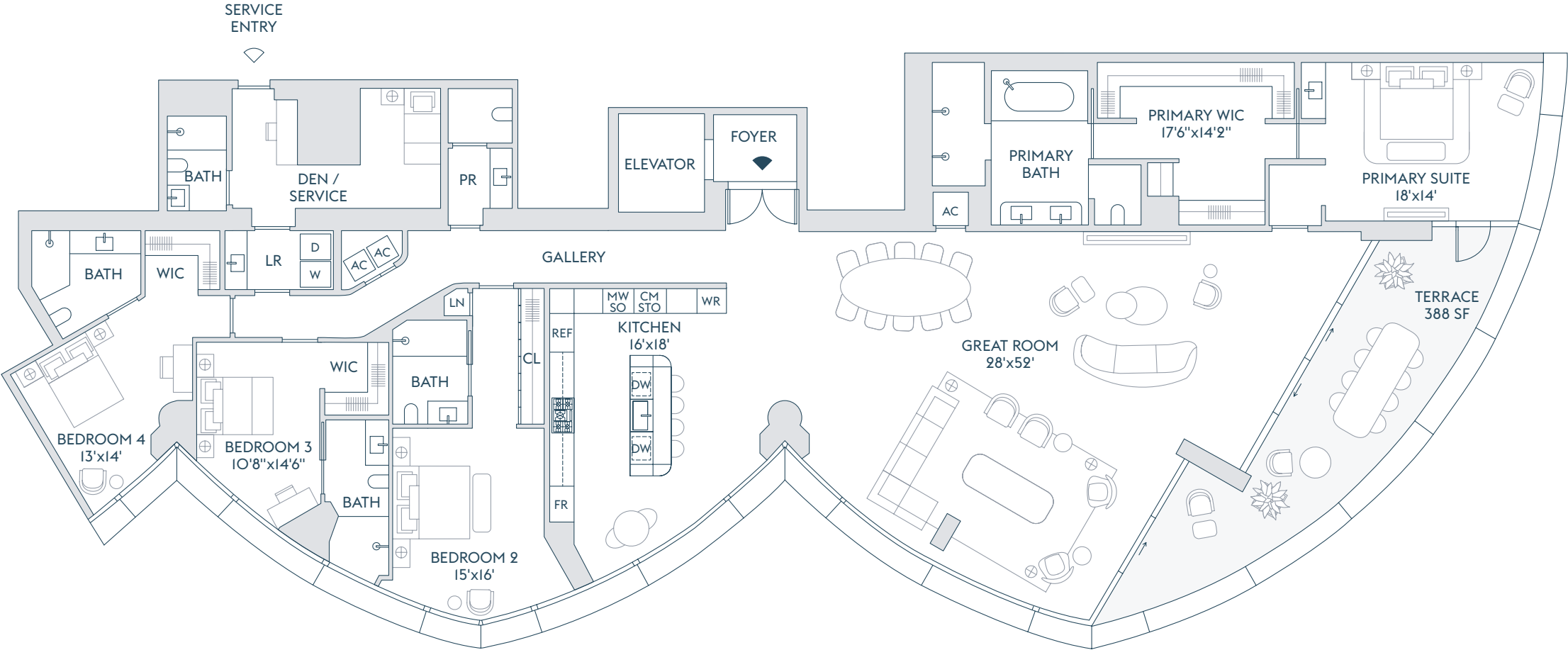

INTRACOASTAL
WATERS

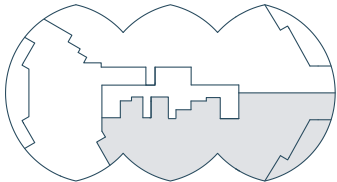

ATLANTIC OCEAN

The dimensions stated for this floor plan are approximate because there are various recognized methods for calculating the square footage of a unit. The square footage stated here is calculated from the exterior boundaries of the exterior walls to the centerline of interior demising walls without deductions for cutouts, curves, or architectural features. This method typically results in quoted dimensions greater than the dimensions that would be determined by using other accepted methods. The definition of "Unit" and the calculation method to be relied upon is set forth by the Developer in Developer's prospectus which method may result in a square footage calculation less than the result of the calculation method used here. Renderings depict features not included with purchase, but which are available at an additional cost such as wine bar and closet millwork among others. Consult the Developer's prospectus to learn what is included with Unit purchase and to understand Unit dimensions. 2024 © Carlton Terrace Owner LLC, with all rights reserved.

RIVAGE

BAL HARBOUR

RESIDENCE

B

FLOORS

3-17

4 BEDROOMS
5 BATHROOMS
POWDER ROOM
DEN / SERVICE

INTERIOR
4,358 SF | 405 SQM

EXTERIOR
388 SF | 36 SQM

TOTAL
4,746 SF | 441 SQM

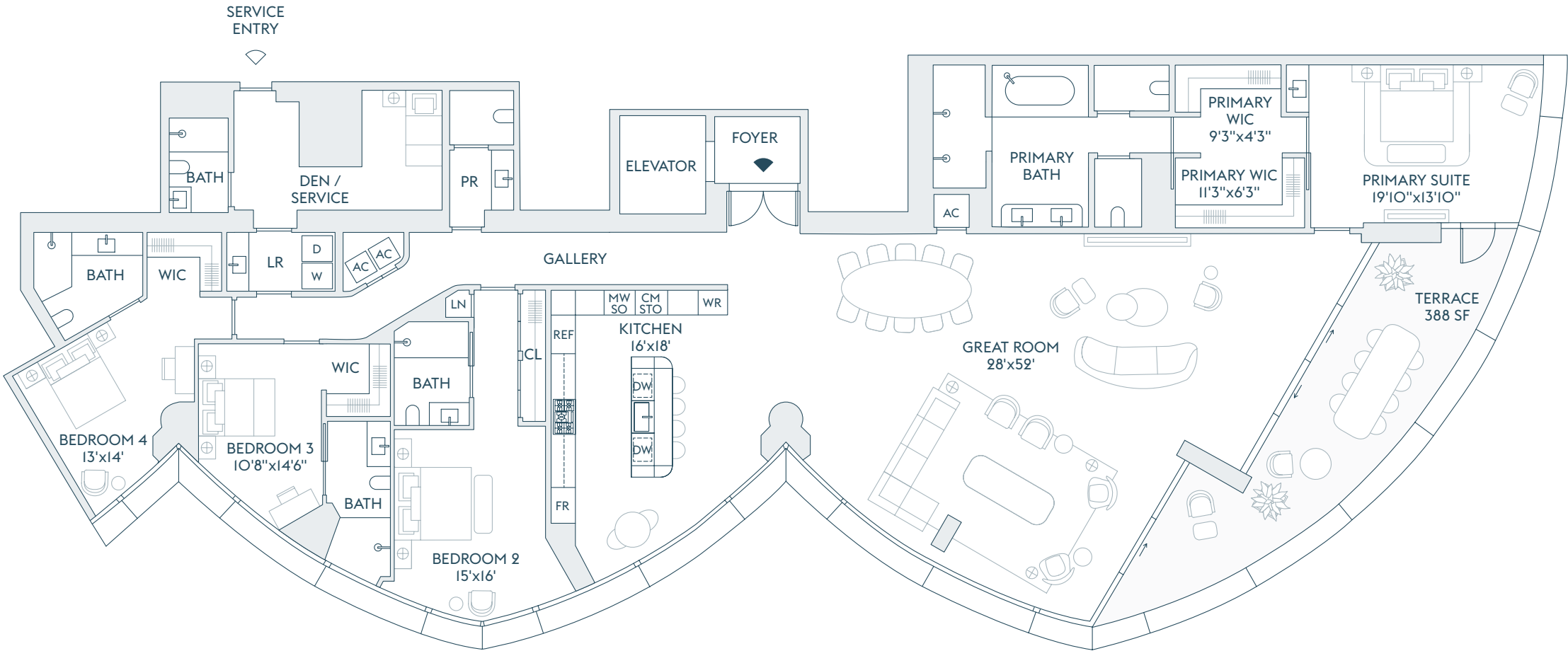

INTRACOASTAL
WATERS

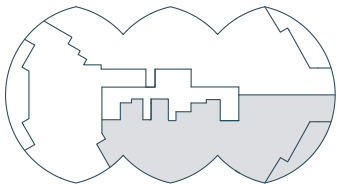

ATLANTIC OCEAN

ALTERNATE PRIMARY SUITE

The dimensions stated for this floor plan are approximate because there are various recognized methods for calculating the square footage of a unit. The square footage stated here is calculated from the exterior boundaries of the exterior walls to the centerline of interior demising walls without deductions for cutouts, curves, or architectural features. This method typically results in quoted dimensions greater than the dimensions that would be determined by using other accepted methods. The definition of "Unit" and the calculation method to be relied upon is set forth by the Developer in Developer's prospectus which method may result in a square footage calculation less than the result of the calculation method used here. Renderings depict features not included with purchase, but which are available at an additional cost such as wine bar and closet millwork among others. Consult the Developer's prospectus to learn what is included with Unit purchase and to understand Unit dimensions. 2024 © Carlton Terrace Owner LLC, with all rights reserved.

RIVAGE

BAL HARBOUR

RESIDENCE

B

FLOORS

18-21

4 BEDROOMS
6 BATHROOMS
POWDER ROOM
OFFICE / BEDROOM
FAMILY ROOM
SERVICE

INTERIOR
5,810 SF | 540 SQM

EXTERIOR
485 SF | 45 SQM

TOTAL
6,295 SF | 585 SQM

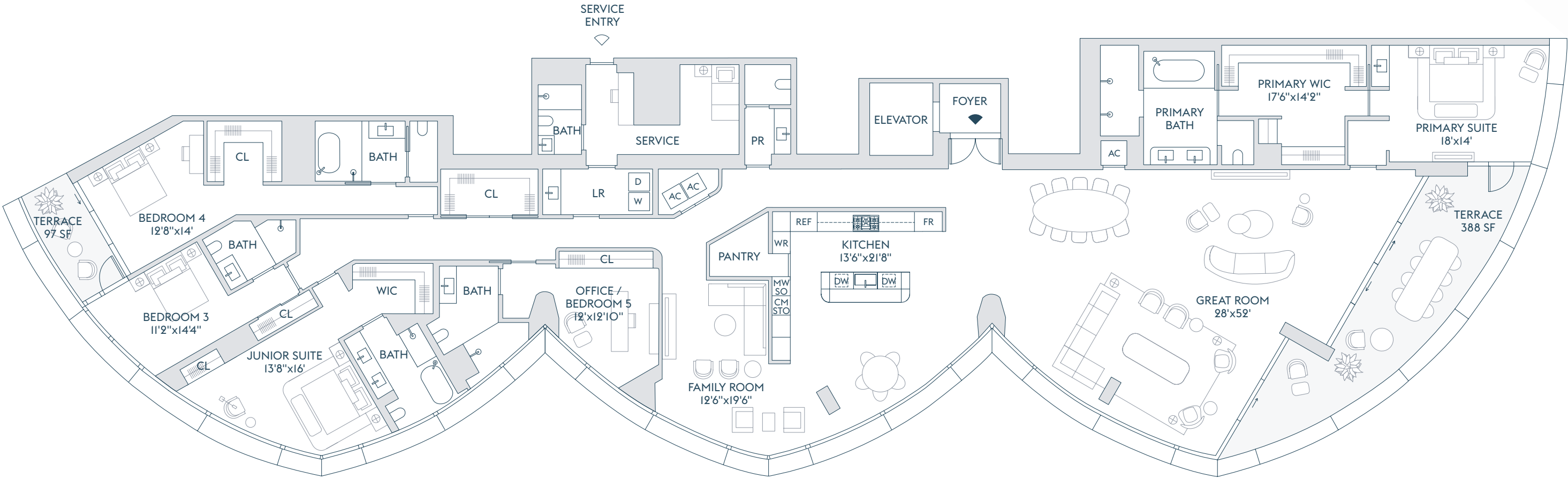

INTRACOASTAL
WATERS

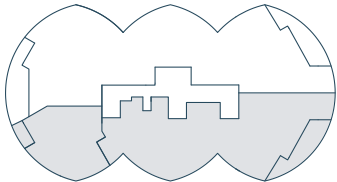

ATLANTIC OCEAN

The dimensions stated for this floor plan are approximate because there are various recognized methods for calculating the square footage of a unit. The square footage stated here is calculated from the exterior boundaries of the exterior walls to the centerline of interior demising walls without deductions for cutouts, curves, or architectural features. This method typically results in quoted dimensions greater than the dimensions that would be determined by using other accepted methods. The definition of "Unit" and the calculation method to be relied upon is set forth by the Developer in Developer's prospectus which method may result in a square footage calculation less than the result of the calculation method used here. Renderings depict features not included with purchase, but which are available at an additional cost such as wine bar and closet millwork among others. Consult the Developer's prospectus to learn what is included with Unit purchase and to understand Unit dimensions. 2024 © Carlton Terrace Owner LLC, with all rights reserved.

RIVAGE

BAL HARBOUR

RESIDENCE

B

FLOORS

18-21

4 BEDROOMS
6 BATHROOMS
POWDER ROOM
OFFICE / BEDROOM
FAMILY ROOM
SERVICE

INTERIOR
5,810 SF | 540 SQM

EXTERIOR
485 SF | 45 SQM

TOTAL
6,295 SF | 585 SQM

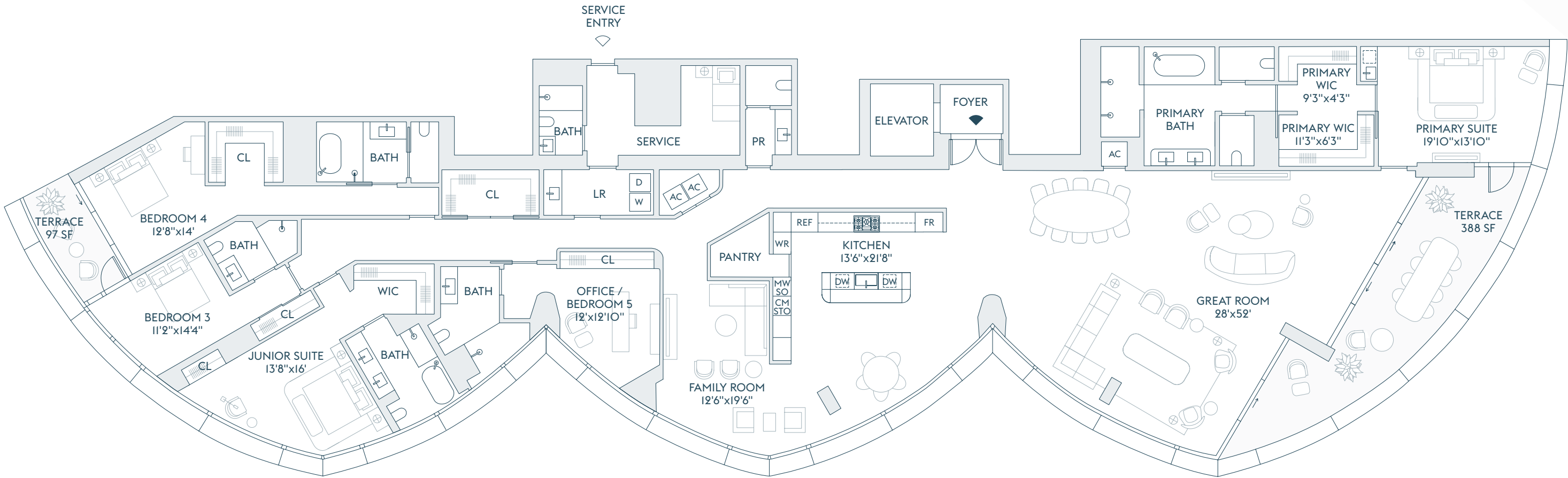

INTRACOASTAL
WATERS

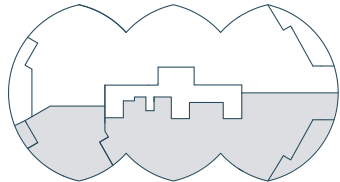

ATLANTIC OCEAN

ALTERNATE PRIMARY SUITE

The dimensions stated for this floor plan are approximate because there are various recognized methods for calculating the square footage of a unit. The square footage stated here is calculated from the exterior boundaries of the exterior walls to the centerline of interior demising walls without deductions for cutouts, curves, or architectural features. This method typically results in quoted dimensions greater than the dimensions that would be determined by using other accepted methods. The definition of "Unit" and the calculation method to be relied upon is set forth by the Developer in Developer's prospectus which method may result in a square footage calculation less than the result of the calculation method used here. Renderings depict features not included with purchase, but which are available at an additional cost such as wine bar and closet millwork among others. Consult the Developer's prospectus to learn what is included with Unit purchase and to understand Unit dimensions. 2024 © Carlton Terrace Owner LLC, with all rights reserved.

RIVAGE

BAL HARBOUR

RESIDENCE FLOOR

C 2

3 BEDROOMS
3 BATHROOMS
POWDER ROOM

INTERIOR
3,284 SF | 305 SQM

EXTERIOR
585 SF | 54 SQM

TOTAL
3,869 SF | 359 SQM

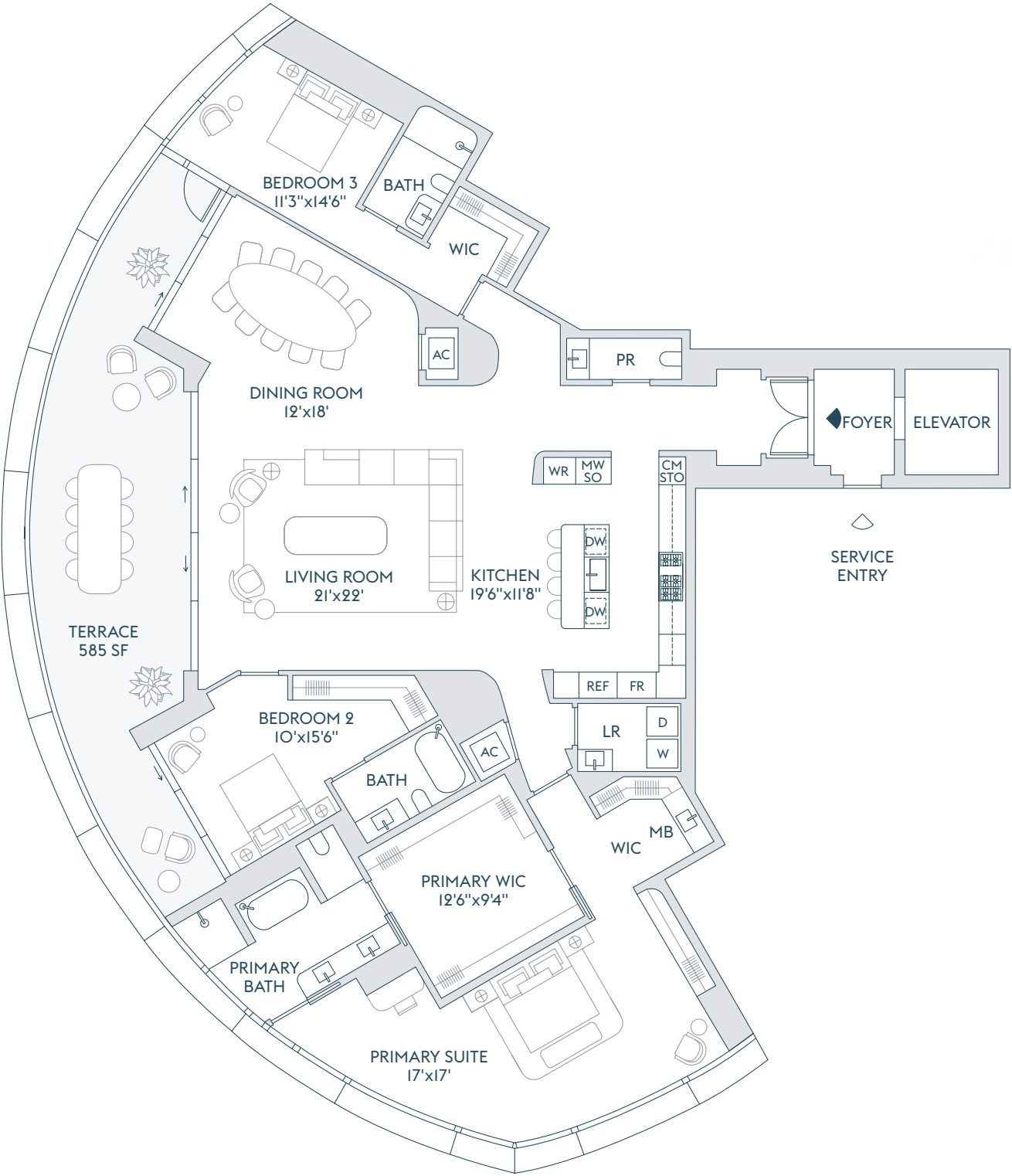

INTRACOASTAL
WATERS

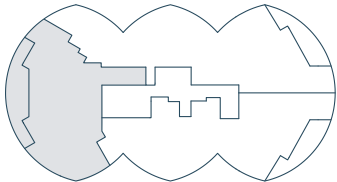

ATLANTIC OCEAN

The dimensions stated for this floor plan are approximate because there are various recognized methods for calculating the square footage of a unit. The square footage stated here is calculated from the exterior boundaries of the exterior walls to the centerline of interior demising walls without deductions for cutouts, curves, or architectural features. This method typically results in quoted dimensions greater than the dimensions that would be determined by using other accepted methods. The definition of "Unit" and the calculation method to be relied upon is set forth by the Developer in Developer's prospectus which method may result in a square footage calculation less than the result of the calculation method used here. Renderings depict features not included with purchase, but which are available at an additional cost such as wine bar and closet millwork among others. Consult the Developer's prospectus to learn what is included with Unit purchase and to understand Unit dimensions. 2024 © Carlton Terrace Owner LLC, with all rights reserved.

RIVAGE

BAL HARBOUR

RESIDENCE

FLOORS

C 3-17

3 BEDROOMS
3 BATHROOMS
POWDER ROOM

INTERIOR
3,297 SF | 306 SQM

EXTERIOR
585 SF | 54 SQM

TOTAL
3,882 SF | 361 SQM

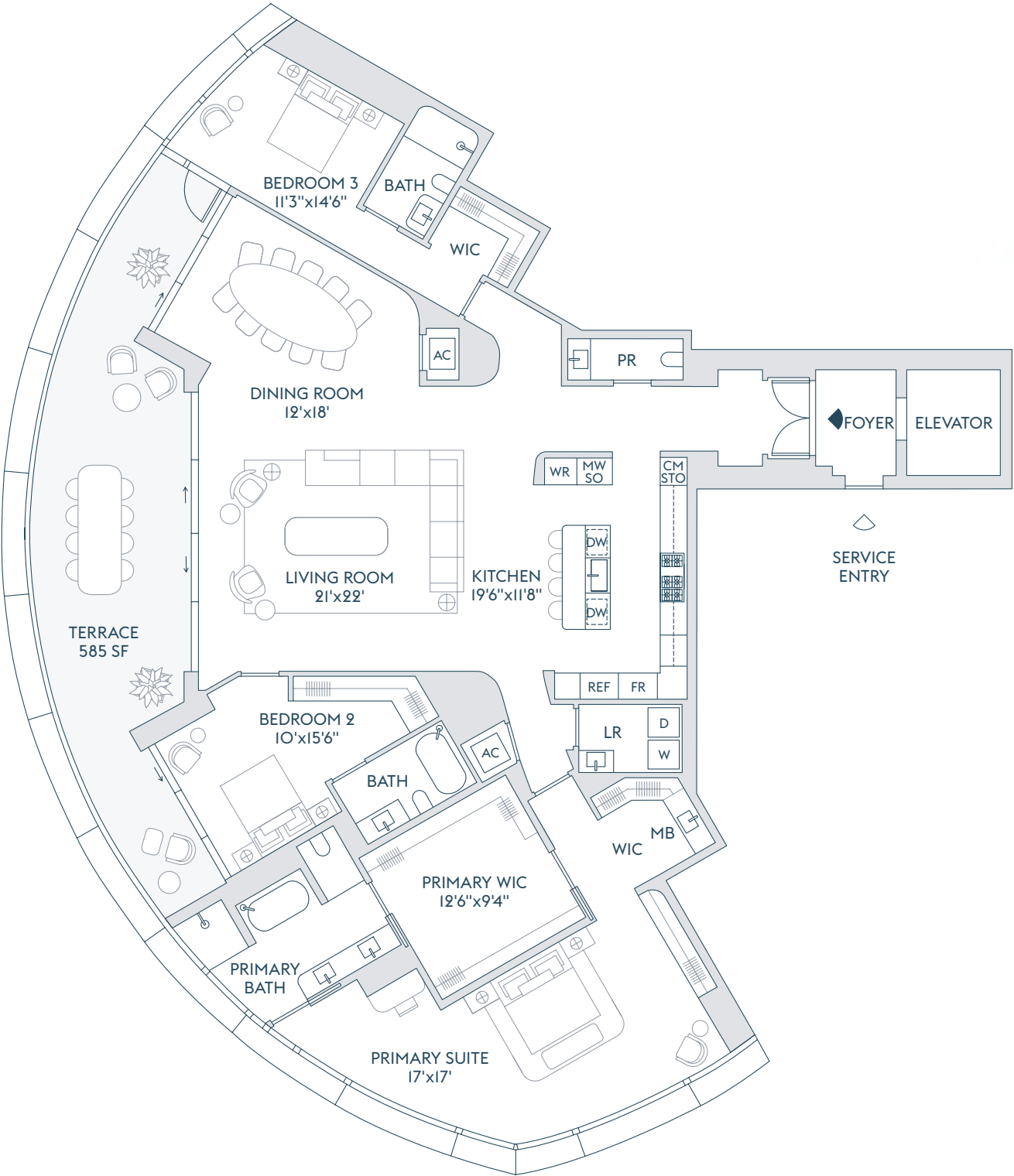

INTRACOASTAL
WATERS

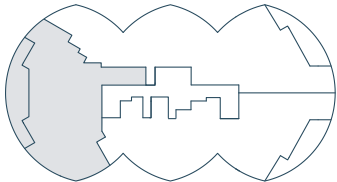

ATLANTIC OCEAN

The dimensions stated for this floor plan are approximate because there are various recognized methods for calculating the square footage of a unit. The square footage stated here is calculated from the exterior boundaries of the exterior walls to the centerline of interior demising walls without deductions for cutouts, curves, or architectural features. This method typically results in quoted dimensions greater than the dimensions that would be determined by using other accepted methods. The definition of "Unit" and the calculation method to be relied upon is set forth by the Developer in Developer's prospectus which method may result in a square footage calculation less than the result of the calculation method used here. Renderings depict features not included with purchase, but which are available at an additional cost such as wine bar and closet millwork among others. Consult the Developer's prospectus to learn what is included with Unit purchase and to understand Unit dimensions. 2024 © Carlton Terrace Owner LLC, with all rights reserved.

RIVAGE

BAL HARBOUR

RESIDENCE

A+C

6 BEDROOMS
7 BATHROOMS
2 POWDER ROOMS
SERVICE

INTERIOR
8,107 SF | 753 SQM

EXTERIOR
973 SF | 90 SQM

TOTAL
9,080 SF | 843 SQM

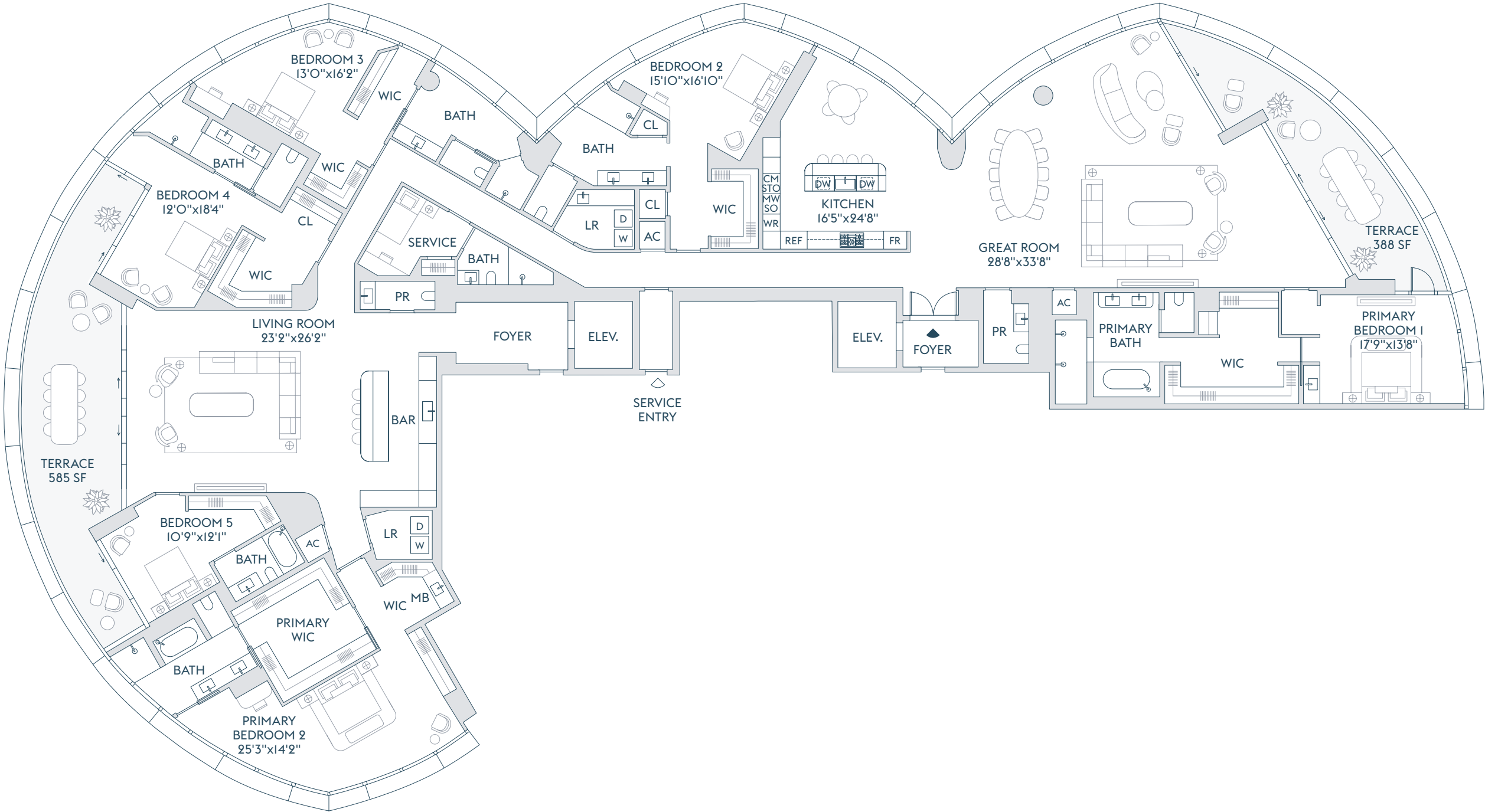

INTRACOASTAL
WATERS

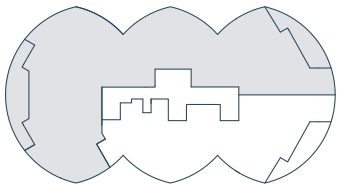

ATLANTIC OCEAN

The dimensions stated for this floor plan are approximate because there are various recognized methods for calculating the square footage of a unit. The square footage stated here is calculated from the exterior boundaries of the exterior walls to the centerline of interior demising walls without deductions for cutouts, curves, or architectural features. This method typically results in quoted dimensions greater than the dimensions that would be determined by using other accepted methods. The definition of "Unit" and the calculation method to be relied upon is set forth by the Developer in Developer's prospectus which method may result in a square footage calculation less than the result of the calculation method used here. Renderings depict features not included with purchase, but which are available at an additional cost such as wine bar and closet millwork among others. Consult the Developer's prospectus to learn what is included with Unit purchase and to understand Unit dimensions. 2024 © Carlton Terrace Owner LLC, with all rights reserved.

RESIDENCE

B+C

BAL HARBOUR

6 BEDROOMS
7 BATHROOMS
3 POWDER ROOMS
SERVICE

INTERIOR
7,655 SF | 711 SQM

EXTERIOR
973 SF | 90 SQM

TOTAL
8,628 SF | 801 SQM

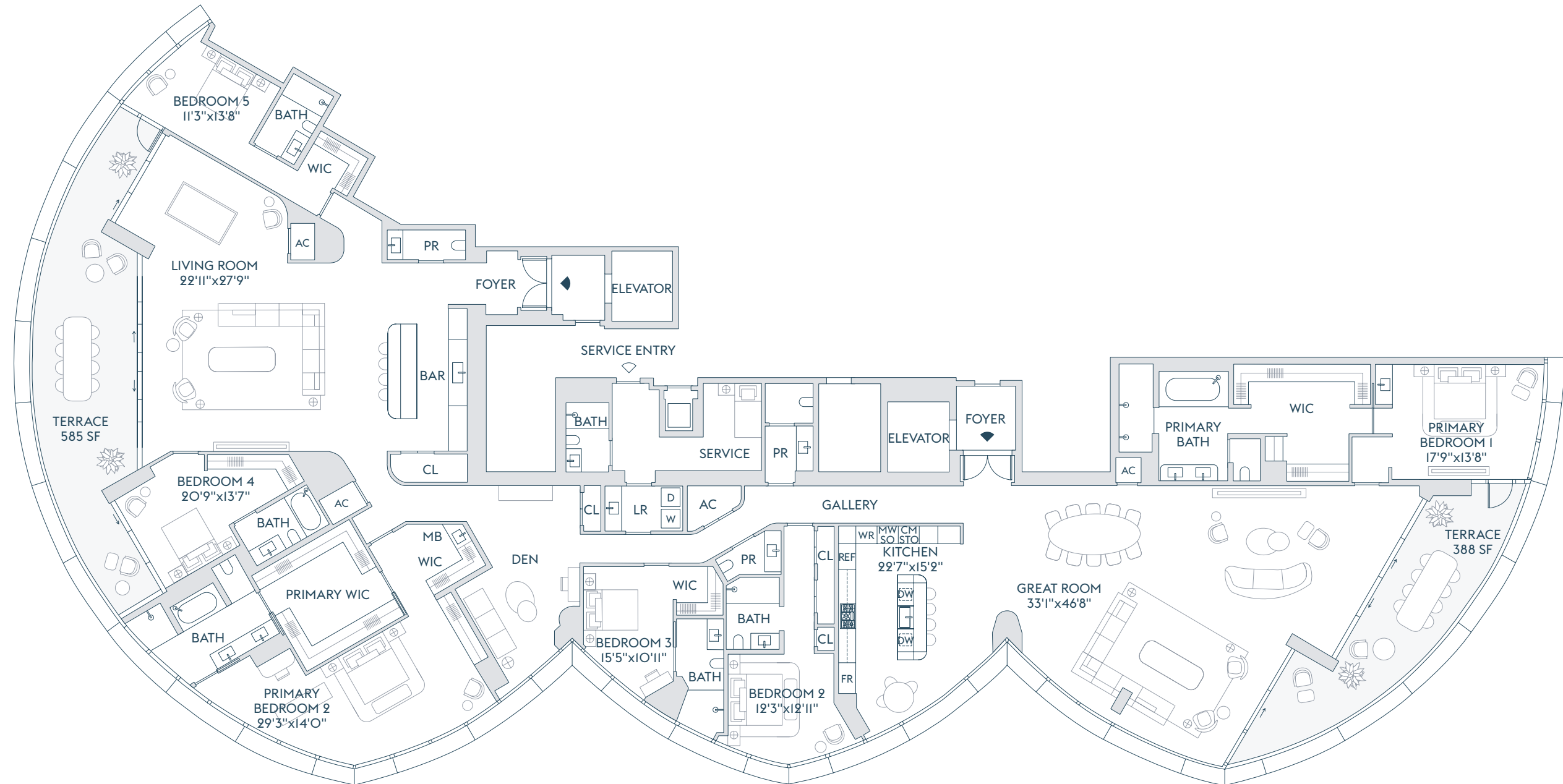

INTRACOASTAL
WATERS

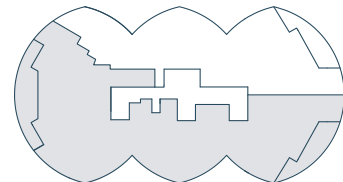

ATLANTIC OCEAN

The dimensions stated for this floor plan are approximate because there are various recognized methods for calculating the square footage of a unit. The square footage stated here is calculated from the exterior boundaries of the exterior walls to the centerline of interior demising walls without deductions for cutouts, curves, or architectural features. This method typically results in quoted dimensions greater than the dimensions that would be determined by using other accepted methods. The definition of "Unit" and the calculation method to be relied upon is set forth by the Developer in Developer's prospectus which method may result in a square footage calculation less than the result of the calculation method used here. Renderings depict features not included with purchase, but which are available at an additional cost such as wine bar and closet millwork among others. Consult the Developer's prospectus to learn what is included with Unit purchase and to understand Unit dimensions. 2024 © Carlton Terrace Owner LLC, with all rights reserved. 

RIVAGE

BAL HARBOUR

LOWER PENTHOUSE FLOOR

A 22

- 5 BEDROOMS
- 7 BATHROOMS
- POWDER ROOM
- DEN
- SERVICE
- FAMILY ROOM
- PRIVATE ELEVATOR

INTERIOR
8,239 SF | 765 SQM

EXTERIOR
776 SF | 72 SQM

TOTAL
9,015 SF | 837 SQM

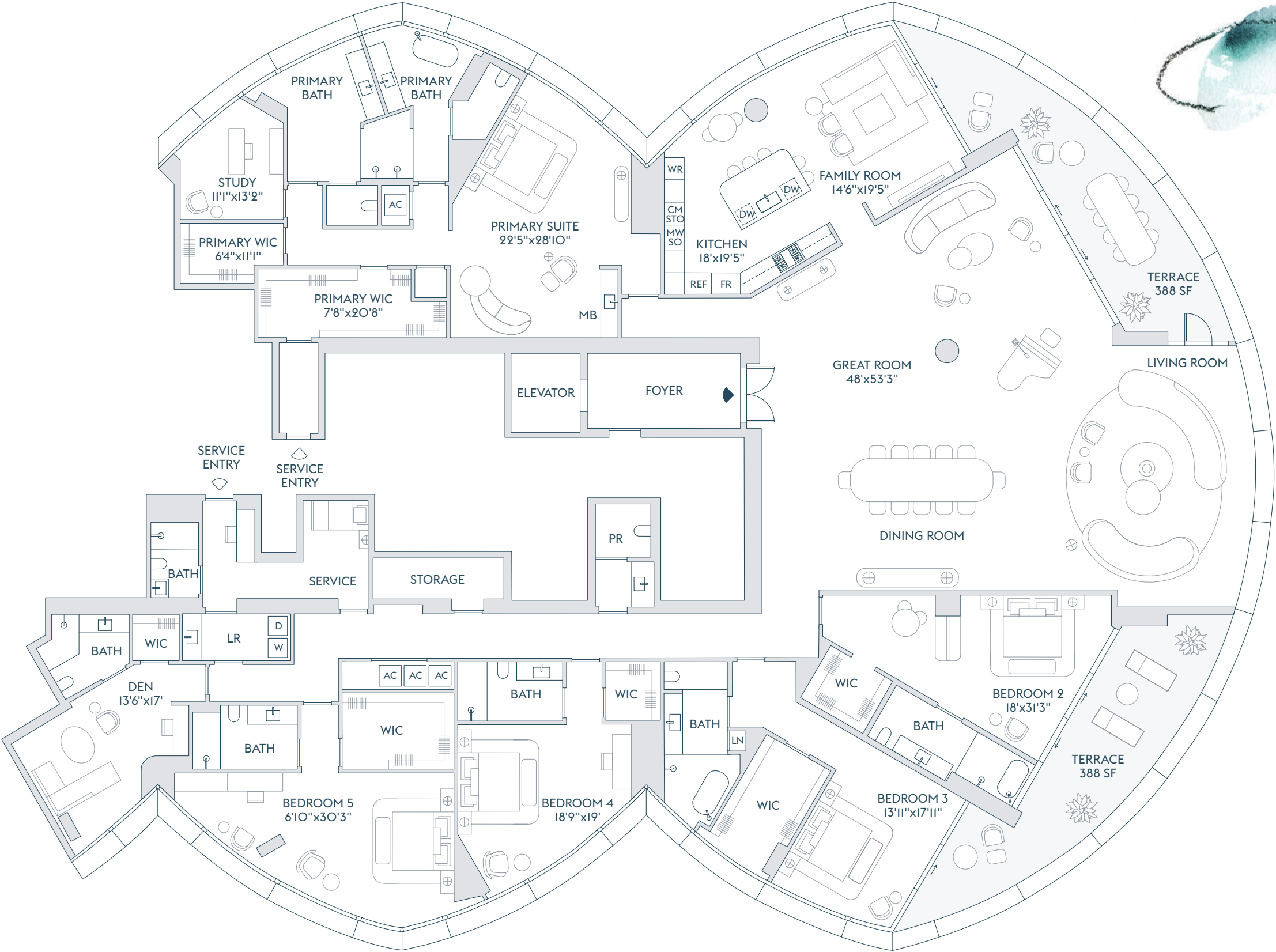

FLOOR 22

The dimensions stated for this floor plan are approximate because there are various recognized methods for calculating the square footage of a unit. The square footage stated here is calculated from the exterior boundaries of the exterior walls to the centerline of interior demising walls without deductions for cutouts, curves, or architectural features. This method typically results in quoted dimensions greater than the dimensions that would be determined by using other accepted methods. The definition of "Unit" and the calculation method to be relied upon is set forth by the Developer in Developer's prospectus which method may result in a square footage calculation less than the result of the calculation method used here. Renderings depict features not included with purchase, but which are available at an additional cost such as wine bar and closet millwork among others. Consult the Developer's prospectus to learn what is included with Unit purchase and to understand Unit dimensions. 2024 © Carlton Terrace Owner LLC, with all rights reserved.

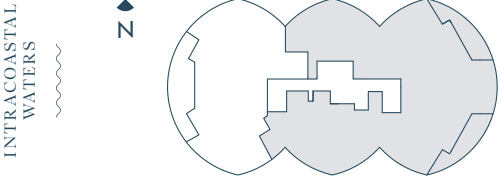

RIVAGE

BAL HARBOUR

OCEAN
PENTHOUSE FLOORS

A 23, 24, 25

5 BEDROOMS
6 BATHROOMS
3 POWDER ROOMS
DEN / SERVICE
MEDIA ROOM
GAME ROOM
LIBRARY / LOUNGE
FITNESS STUDIO
OUTDOOR KITCHEN
POOL
PRIVATE ELEVATOR

INTERIOR
12,517 SF | 1,163 SQM

EXTERIOR
6,425 SF | 597 SQM

TOTAL
18,942 SF | 1,760 SQM

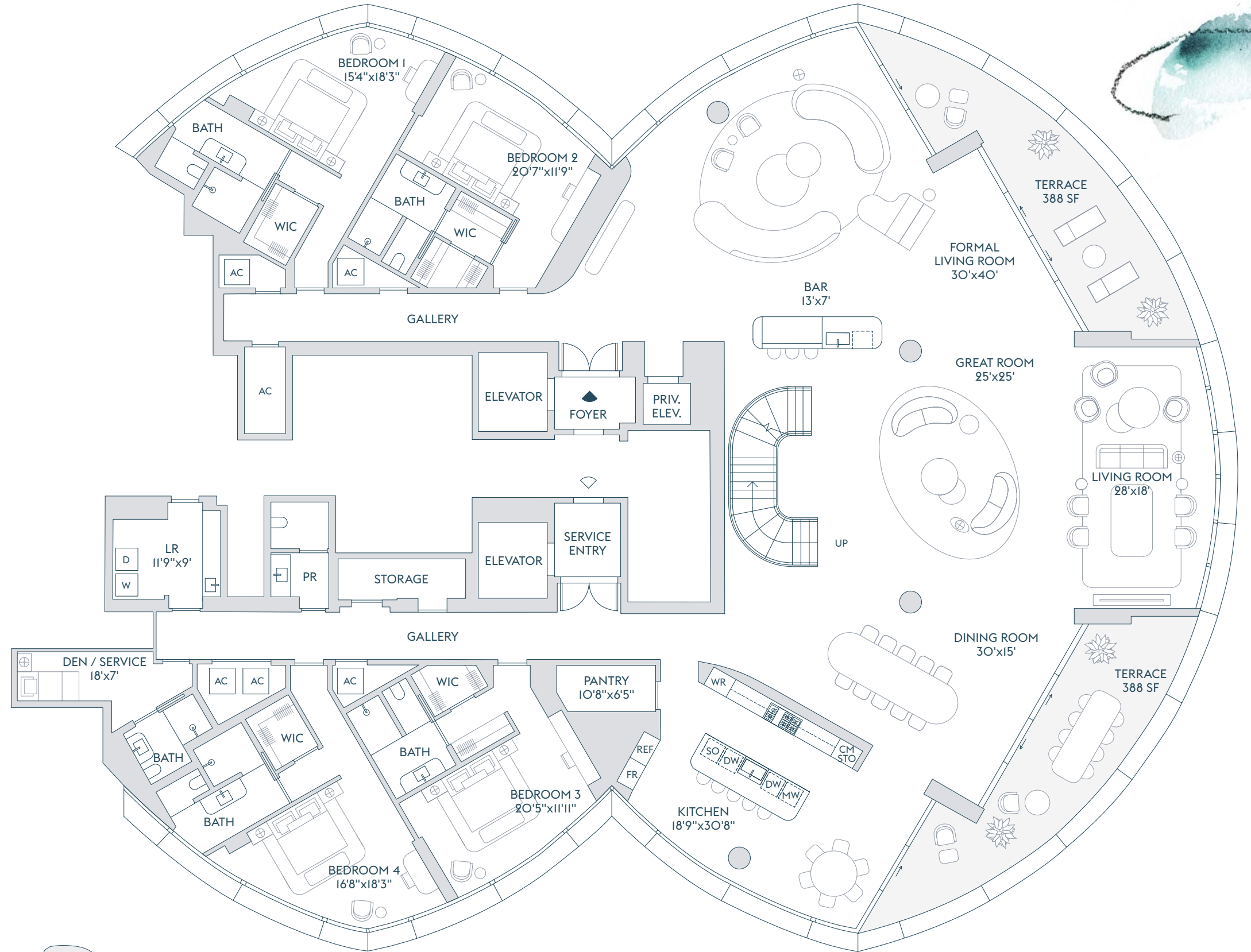

FLOOR 23

The dimensions stated for this floor plan are approximate because there are various recognized methods for calculating the square footage of a unit. The square footage stated here is calculated from the exterior boundaries of the exterior walls to the centerline of interior demising walls without deductions for cutouts, curves, or architectural features. This method typically results in quoted dimensions greater than the dimensions that would be determined by using other accepted methods. The definition of "Unit" and the calculation method to be relied upon is set forth by the Developer in Developer's prospectus which method may result in a square footage calculation less than the result of the calculation method used here. Renderings depict features not included with purchase, but which are available at an additional cost such as wine bar and closet millwork among others. Consult the Developer's prospectus to learn what is included with Unit purchase and to understand Unit dimensions. 2025 © Carlton Terrace Owner LLC, with all rights reserved. 

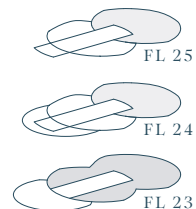
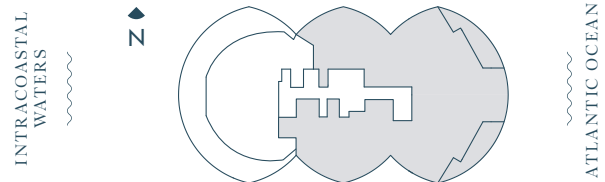

RIVAGE

BAL HARBOUR

OCEAN
PENTHOUSE FLOORS

A 23, 24, 25

- 5 BEDROOMS
- 6 BATHROOMS
- 3 POWDER ROOMS
- DEN / SERVICE
- MEDIA ROOM
- GAME ROOM
- LIBRARY / LOUNGE
- FITNESS STUDIO
- OUTDOOR KITCHEN
- POOL
- PRIVATE ELEVATOR

INTERIOR
12,517 SF | 1,163 SQM

EXTERIOR
6,425 SF | 597 SQM

TOTAL
18,942 SF | 1,760 SQM

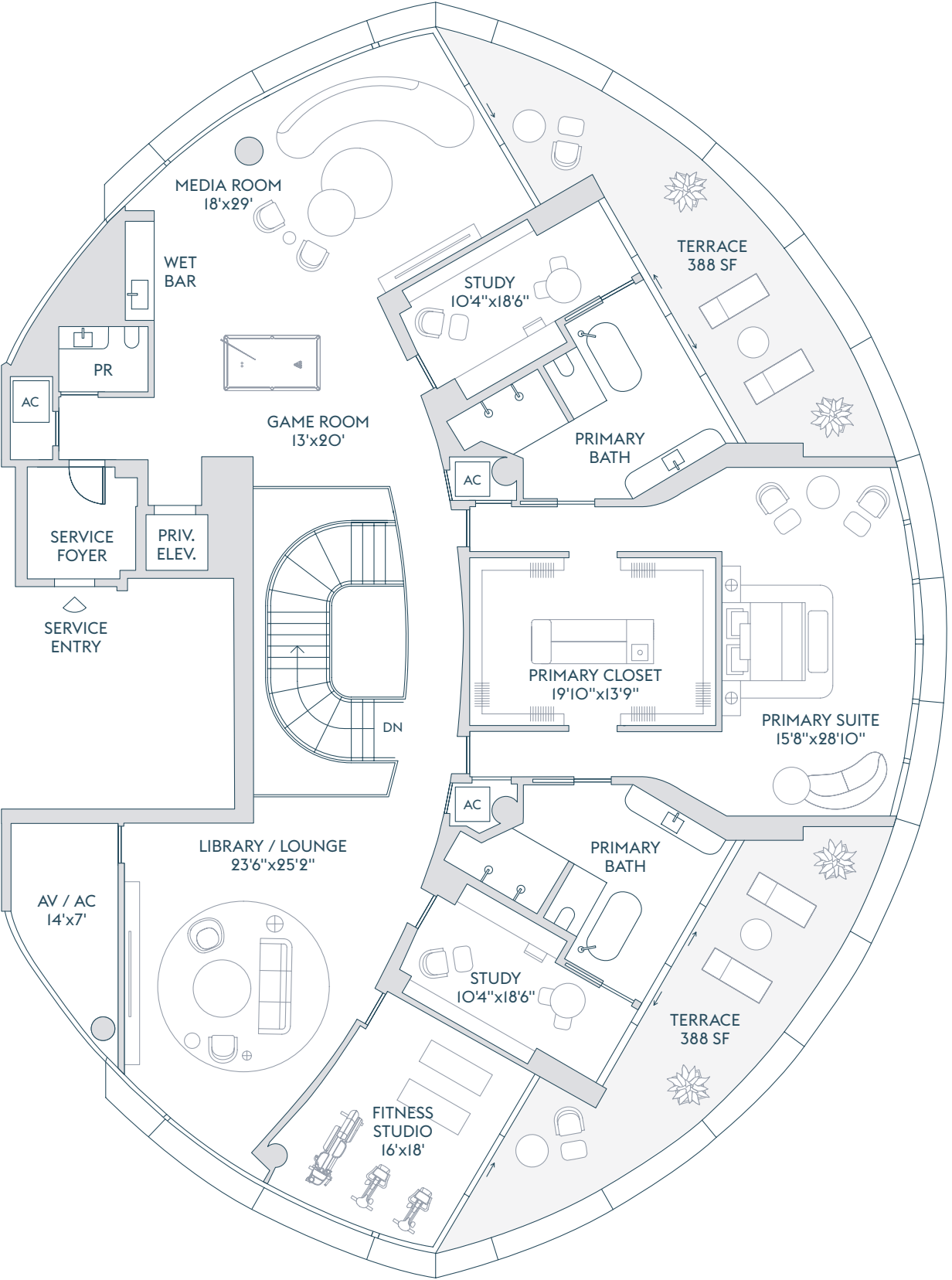

FLOOR 24

The dimensions stated for this floor plan are approximate because there are various recognized methods for calculating the square footage of a unit. The square footage stated here is calculated from the exterior boundaries of the exterior walls to the centerline of interior demising walls without deductions for cutouts, curves, or architectural features. This method typically results in quoted dimensions greater than the dimensions that would be determined by using other accepted methods. The definition of "Unit" and the calculation method to be relied upon is set forth by the Developer in Developer's prospectus which method may result in a square footage calculation less than the result of the calculation method used here. Renderings depict features not included with purchase, but which are available at an additional cost such as wine bar and closet millwork among others. Consult the Developer's prospectus to learn what is included with Unit purchase and to understand Unit dimensions. 2025 © Carlton Terrace Owner LLC, with all rights reserved.

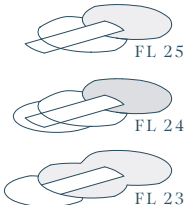
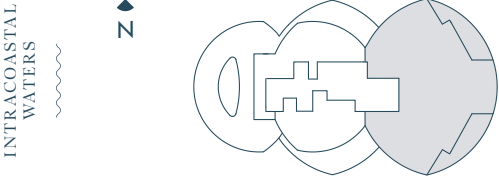

RIVAGE

BAL HARBOUR

OCEAN
PENTHOUSE FLOORS

A 23, 24, 25

- 5 BEDROOMS
- 6 BATHROOMS
- 3 POWDER ROOMS
- DEN / SERVICE
- MEDIA ROOM
- GAME ROOM
- LIBRARY / LOUNGE
- FITNESS STUDIO
- OUTDOOR KITCHEN
- POOL
- PRIVATE ELEVATOR

INTERIOR
12,517 SF | 1,163 SQM

EXTERIOR
6,425 SF | 597 SQM

TOTAL
18,942 SF | 1,760 SQM

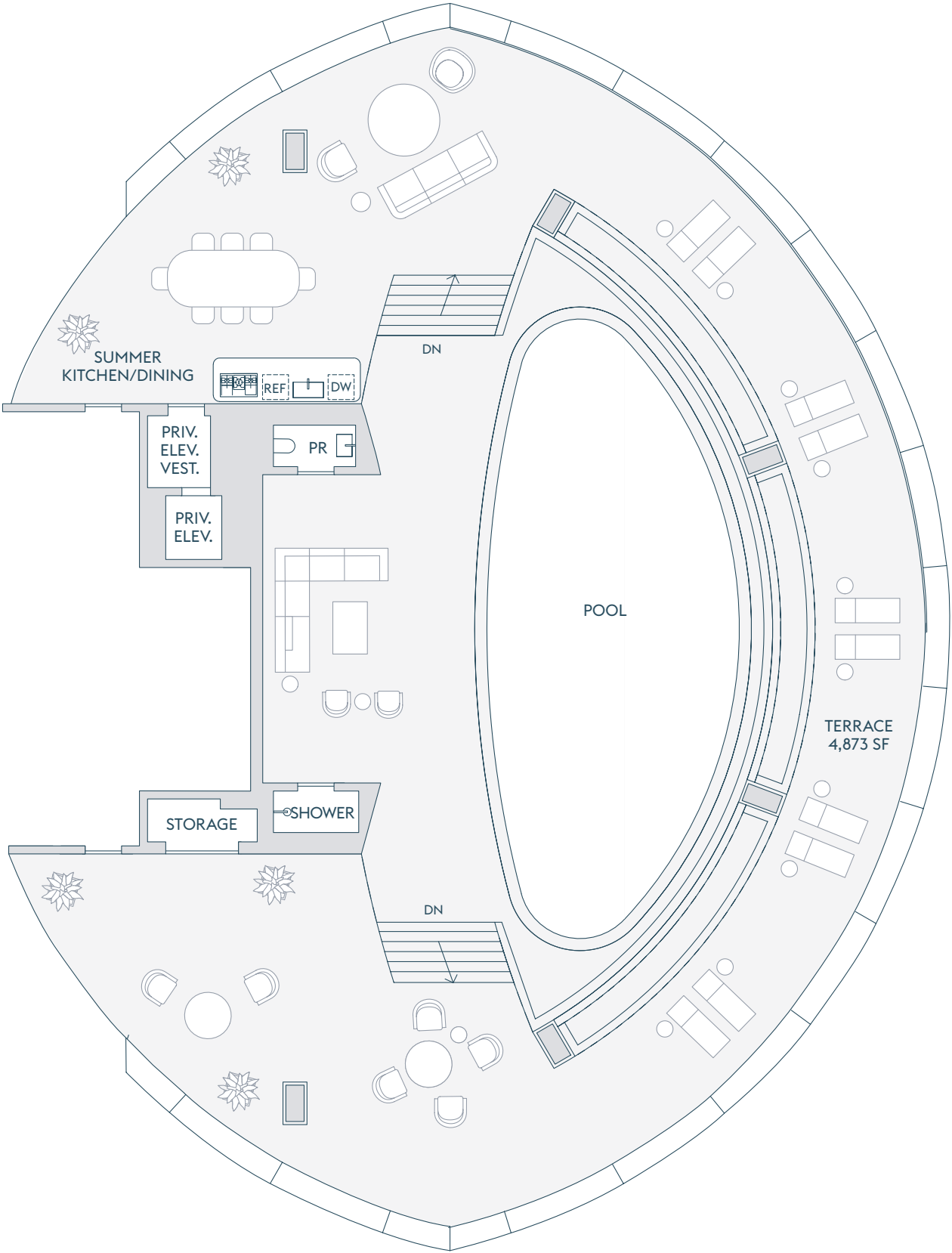

FLOOR 25

The dimensions stated for this floor plan are approximate because there are various recognized methods for calculating the square footage of a unit. The square footage stated here is calculated from the exterior boundaries of the exterior walls to the centerline of interior demising walls without deductions for cutouts, curves, or architectural features. This method typically results in quoted dimensions greater than the dimensions that would be determined by using other accepted methods. The definition of “Unit” and the calculation method to be relied upon is set forth by the Developer in Developer’s prospectus which method may result in a square footage calculation less than the result of the calculation method used here. Renderings depict features not included with purchase, but which are available at an additional cost such as wine bar and closet millwork among others. Consult the Developer’s prospectus to learn what is included with Unit purchase and to understand Unit dimensions. 2025 © Carlton Terrace Owner LLC, with all rights reserved.

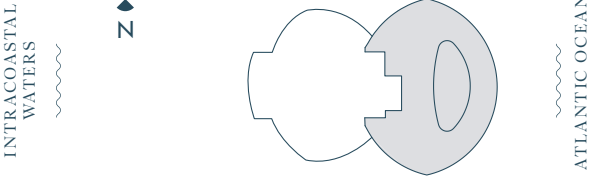

BAL HARBOUR

BAY
PENTHOUSE FLOORS

C 22, 23, 24

6 BEDROOMS
9 BATHROOMS
POWDER ROOM
2 DEN / SERVICE
FAMILY ROOM
FITNESS STUDIO
SKY ROOM
OUTDOOR KITCHEN
POOL
PRIVATE ELEVATOR

INTERIOR
10,029 SF | 932 SQM

EXTERIOR
6,101 SF | 567 SQM

TOTAL
16,130 SF | 1,499 SQM

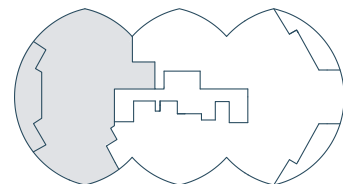

ATLANTIC OCEAN

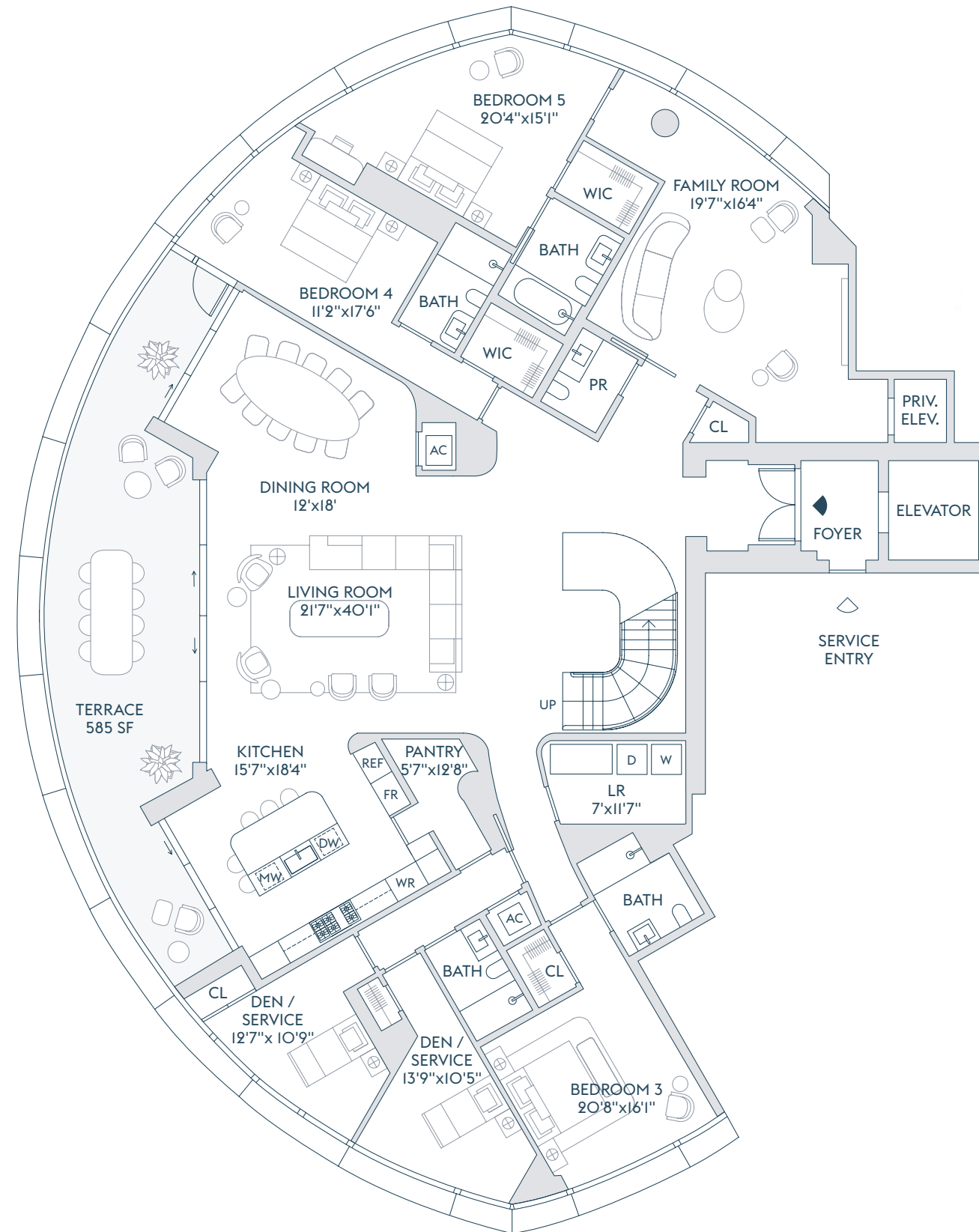
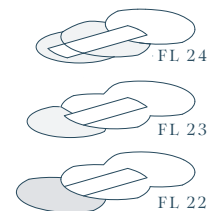

FLOOR 22

The dimensions stated for this floor plan are approximate because there are various recognized methods for calculating the square footage of a unit. The square footage stated here is calculated from the exterior boundaries of the exterior walls to the centerline of interior demising walls without deductions for cutouts, curves, or architectural features. This method typically results in quoted dimensions greater than the dimensions that would be determined by using other accepted methods. The definition of "Unit" and the calculation method to be relied upon is set forth by the Developer in Developer's prospectus which method may result in a square footage calculation less than the result of the calculation method used here. Renderings depict features not included with purchase, but which are available at an additional cost such as wine bar and closet millwork among others. Consult the Developer's prospectus to learn what is included with Unit purchase and to understand Unit dimensions. 2024 © Carlton Terrace Owner LLC, with all rights reserved.

RIVAGE

BAL HARBOUR

BAY PENTHOUSE FLOORS

C 22, 23, 24

- 6 BEDROOMS
- 9 BATHROOMS
- POWDER ROOM
- 2 DEN / SERVICE
- FAMILY ROOM
- FITNESS STUDIO
- SKY ROOM
- OUTDOOR KITCHEN
- POOL
- PRIVATE ELEVATOR

INTERIOR
10,029 SF | 932 SQM

EXTERIOR
6,101 SF | 567 SQM

TOTAL
16,130 SF | 1,499 SQM

INTRACOASTAL
WATERS

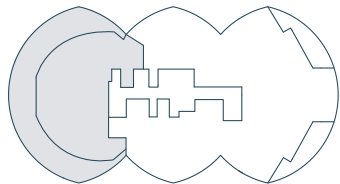

ATLANTIC OCEAN

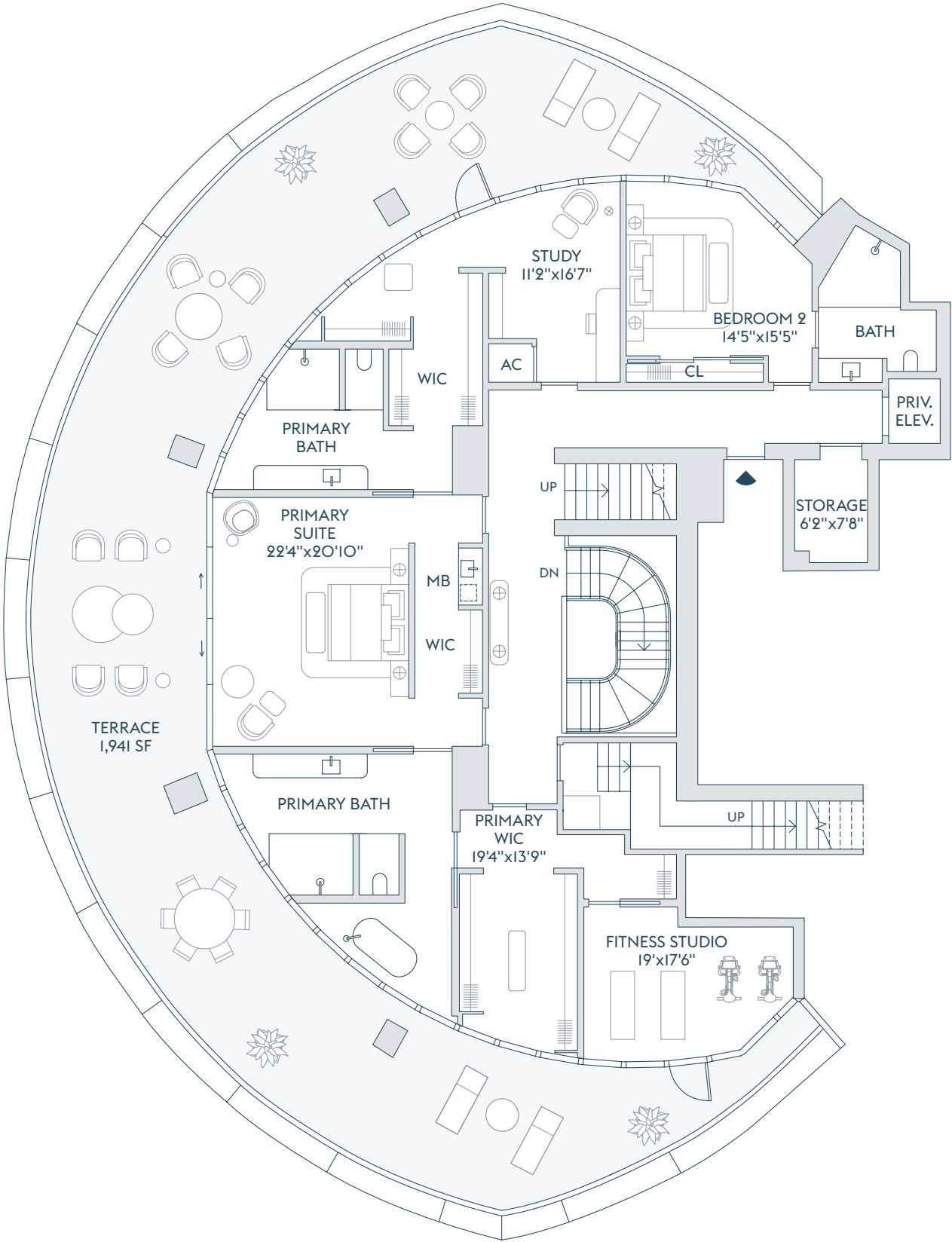
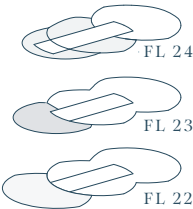

FLOOR 23

The dimensions stated for this floor plan are approximate because there are various recognized methods for calculating the square footage of a unit. The square footage stated here is calculated from the exterior boundaries of the exterior walls to the centerline of interior demising walls without deductions for cutouts, curves, or architectural features. This method typically results in quoted dimensions greater than the dimensions that would be determined by using other accepted methods. The definition of "Unit" and the calculation method to be relied upon is set forth by the Developer in Developer's prospectus which method may result in a square footage calculation less than the result of the calculation method used here. Renderings depict features not included with purchase, but which are available at an additional cost such as wine bar and closet millwork among others. Consult the Developer's prospectus to learn what is included with Unit purchase and to understand Unit dimensions. 2024 © Carlton Terrace Owner LLC, with all rights reserved.

RIVAGE

BAL HARBOUR

BAY PENTHOUSE FLOORS

C 22, 23, 24

- 6 BEDROOMS
- 9 BATHROOMS
- POWDER ROOM
- 2 DEN / SERVICE
- FAMILY ROOM
- FITNESS STUDIO
- SKY ROOM
- OUTDOOR KITCHEN
- POOL
- PRIVATE ELEVATOR

INTERIOR
10,029 SF | 932 SQM

EXTERIOR
6,101 SF | 567 SQM

TOTAL
16,130 SF | 1,499 SQM

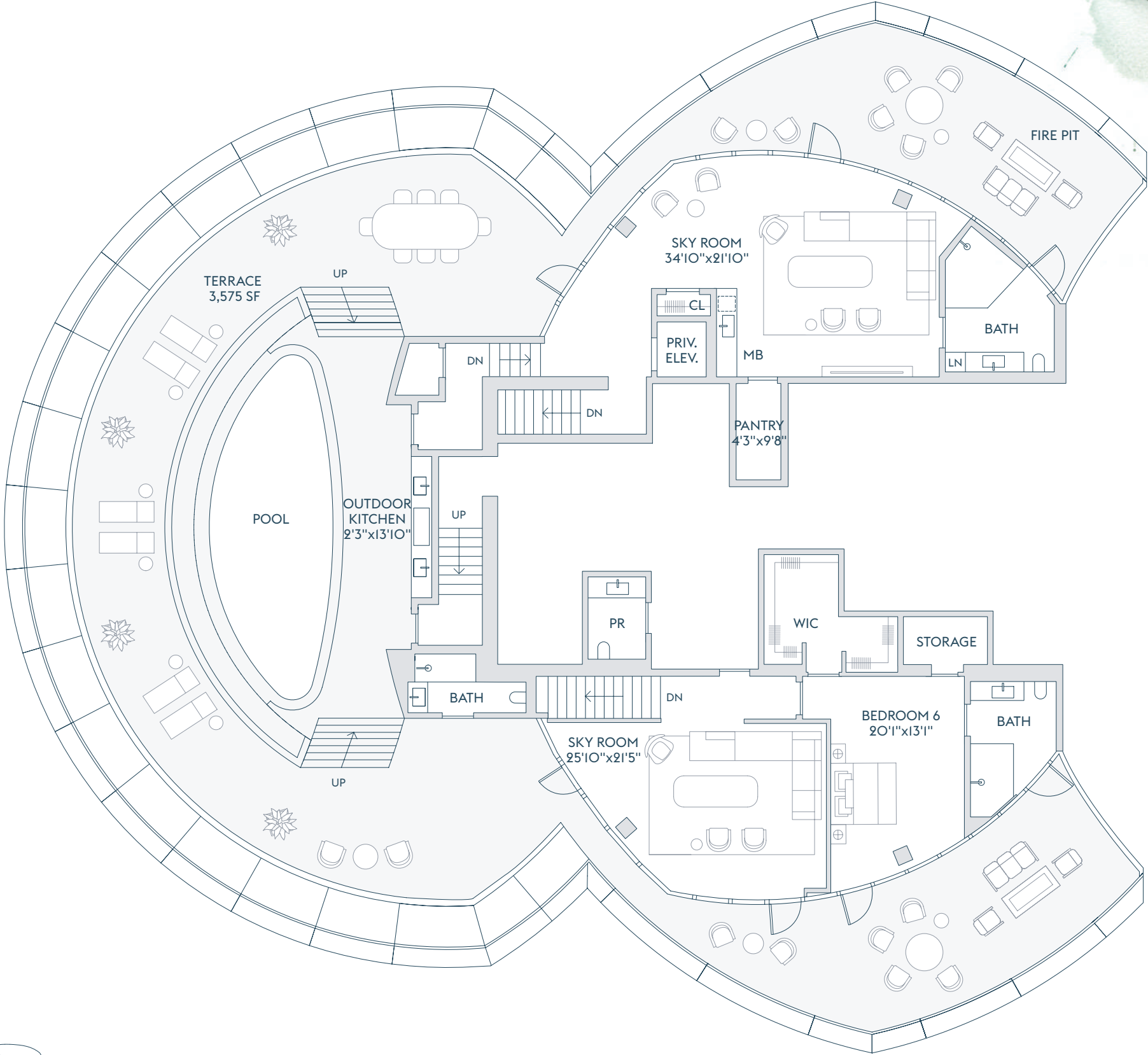

FLOOR 24

The dimensions stated for this floor plan are approximate because there are various recognized methods for calculating the square footage of a unit. The square footage stated here is calculated from the exterior boundaries of the exterior walls to the centerline of interior demising walls without deductions for cutouts, curves, or architectural features. This method typically results in quoted dimensions greater than the dimensions that would be determined by using other accepted methods. The definition of "Unit" and the calculation method to be relied upon is set forth by the Developer in Developer's prospectus which method may result in a square footage calculation less than the result of the calculation method used here. Renderings depict features not included with purchase, but which are available at an additional cost such as wine bar and closet millwork among others. Consult the Developer's prospectus to learn what is included with Unit purchase and to understand Unit dimensions. 2024 © Carlton Terrace Owner LLC, with all rights reserved.

